

Technical Specifications

55355 TW	Freedom One Lectern w/ TW casters (Includes lectern, equipment rack, and unit-to-unit connector kit)
55355 G	Freedom One Lectern w/ glides (Includes lectern, equipment rack, and unit-to-unit connector kit)

55366 TW	Equipment rack w/ TW casters
55366 G	Equipment rack w/ glides
55367	Unit-to-unit connector kit
55368 TW	Freedom One Lectern only w/ TW casters
55368 G	Freedom One Lectern only w/ glides

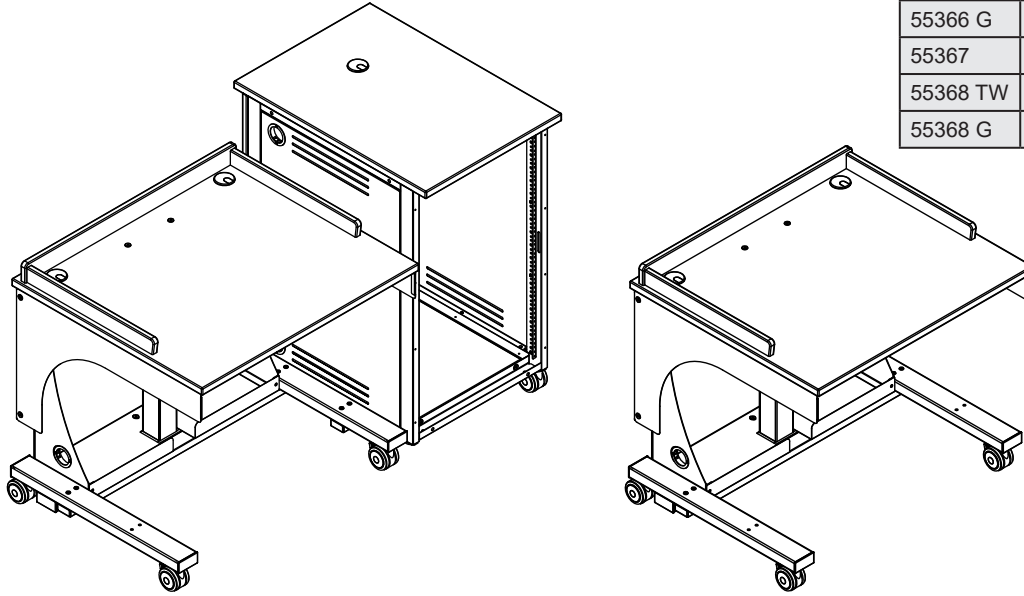

Use the Freedom One Sit-to-Stand Lectern where worksurface height adjustment or ADA compliance is required and rack rail for equipment storage is required. The lectern can have either glides or casters installed for stationary or mobile use. Manually adjust the worksurface height from 30-42" (with casters) with a pneumatic-gas assisted spring. The worksurface has a lift capacity of 38 pounds. The lectern worksurface is 34" wide and 30" deep with two cable holes with grommets and a surround. An optional logo plate can be added to the audience side of the lectern for institution branding. The Equipment Rack can be mounted on the left or the right. The worksurface is 21" wide and 30" deep. The worksurface has a cutout with included cover. An optional power module can be added to this cutout. The Equipment rack has 36 rack units with 18 rack units accessible from the audience side and the presenter sides. The audience side has a locking door, and an optional locking door can be added to the presenter side. Other options can be added including rack-mount accessories (shelves, drawers, cooling fans, and others).

	Base Options
TW - 3" Twin-Wheel casters	(Both options are included)
G - Bell glides	

Features and Benefits

- Adjustable-height workstation easily adjusts between varying seated or standing-use heights
- Smooth, easy lift mechanism with pneumatic spring and mechanical release
- Lightweight with a small overall footprint
- ADA-compliant
- Lectern / equipment rack can be assembled in a left or right-hand configuration
- Lectern available as a stand alone unit
- Surround on movable worksurface provides privacy and styling
- Equipment rack with rack-rail mounting 36RU (18RU front and 18RU rear) simplifies installation for any equipment configuration with enough space for an internal CPU
- Side equipment rack grommet holes and worksurface grommets provide superior cord access (covers included)
- Keyed locking audience-side (and optional front) door provides security and easy-access
- 3" swivel locking Twin-Wheel casters, and stationary bell glides are included (user choice)
- Ventilated equipment rack side panels keep equipment cool
- Scratch and impact-resistant high-pressure laminate tops provide durable, useful worksurfaces for instructors
- Cable grommets throughout unit and cord channel provide easy cord routing
- One 2" grommet in bottom of equipment rack provides cord access below unit
- Two 2" cable grommets (left and right) on the adjustable worksurface provide cable access (covers included)
- Optional solid or acrylic door provides security and access to internal equipment
- Customizable modesty / logo panel (must be specified when ordering)
- Durable powder coated steel chassis provides a long-lasting finish
- Warranted to be free of all defects in materials and workmanship for 10 years
- Assembled in Chippewa Falls, WI, USA

Color Options

Standard laminate / color combinations

Wild Cherry / Black
(CHB)



Fusion Maple / Black
(FMB)



Fusion Maple / Silver Sparkle
(FMS)



Standard color combination refers to the quickest deliverable product color combination. Custom laminates and color combinations are available-additional lead-times and up-charges may apply. Call 1-800-235-1262 for further information.

Construction

- The worksurfaces are constructed from 1" thick composite board with .030" high-pressure laminate on one face, and a balancing phenolic backer on the opposing face
- Metal components consist of 16-gauge and 20-gauge steel
- Worksurface edges are covered with 3mm vinyl
- All metal components are finished with a scratch-resistant powder coat epoxy
- Each Freedom One Lectern and equipment rack ships assembled. Customer assembles casters or glides and attaches equipment rack to lectern if required.

Specifications

Adjustable worksurface height	30"H [76.2 cm] - 42"H [106.7 cm] (with casters) 29.25"H [74.3 cm] - 41.25"H [104.8 cm] (with glides)	
Lectern	0-18 lb [8.2 kg] - Factory-set (normal operation) 18 lb [8.2 kg] - 38 lb [96.5 kg] (max) - Additional force needed to raise worksurface	
Equipment rack	Rack rail: 36RU (18RU front and 18RU rear) Note: <u>One</u> equipment rack can be attached to the lectern on the left <u>or</u> right side. Any additional racks have to be free-standing.	
ADA-compliance*		knee clearances: 33.5"W [85 cm] x 22.375"D [56.8 cm] x 29"H [73.7 cm] (1 person per lectern) <i>*Minimum ADA guidelines for knee clearances are 30"W x 19"D x 27"H</i>
3" Twin Wheel casters	Weight capacity 165 lb [75 kg] each (6 included)	
Worksurface grommet	7.25"W [18.4 cm] x 3.875"D [9.8 cm]	
Optional keyboard tray	21.375"W [54.3 cm] x 15.1875"D [38.6 cm] x 2.1875"H [5.6 cm] (available height to worksurface) <i>worksurface needs to be raised 3.375" for ADA-compliant knee clearance</i>	
Unit weight (nominal)	189 lb [85.8 kg] N/A N/A N/A	55355 - Freedom One Lectern (all 3 components) 55366 - Eq rack only 55367 - Unit-to-unit kit only 55368 - Freedom One Lectern only
Shipping weight (nominal)	272.5 lb [123.7 kg] 94 lb [42.7 kg] 5 lb [2.3 kg] 178 lb [80.8 kg]	55355 - Freedom One Lectern (all 3 components) 55366 - Eq rack only 55367 - Unit-to-unit kit only 55368 - Freedom One Lectern only

Specifications subject to change without notice

Adjustable worksurface includes two 2" grommet holes for routing cords from worksurface (covers included)

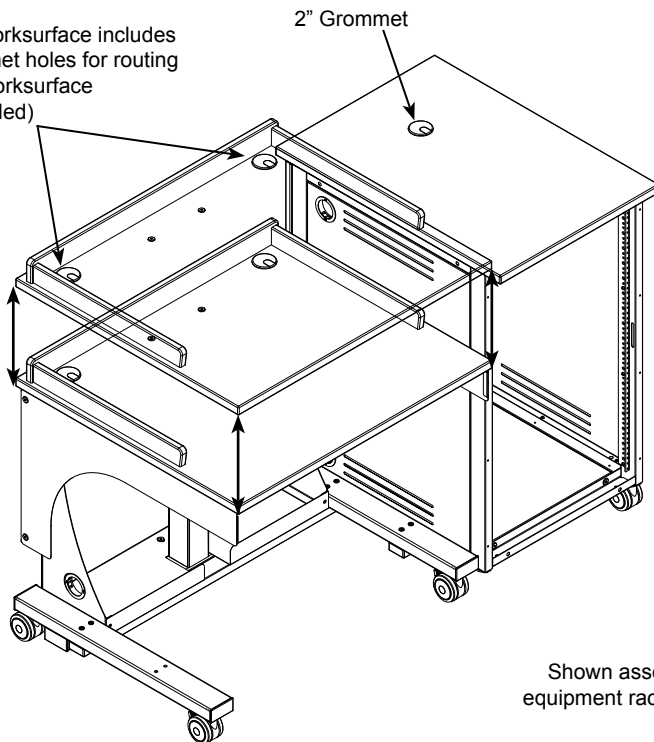

Shown assembled with equipment rack on right side

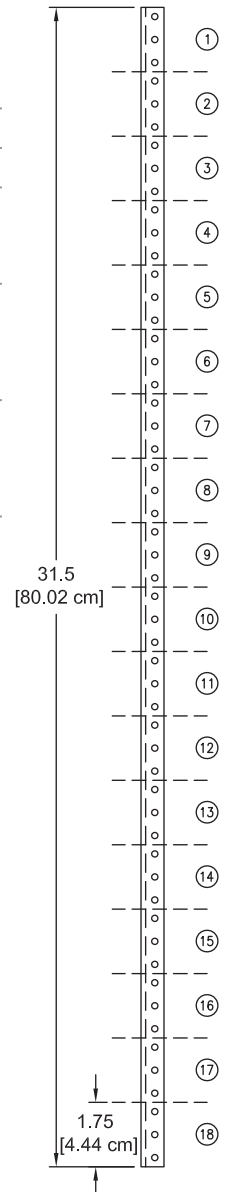

36RU available (18RU front and 18RU rear)

**Freedom One Lectern
with equipment rack
55355**

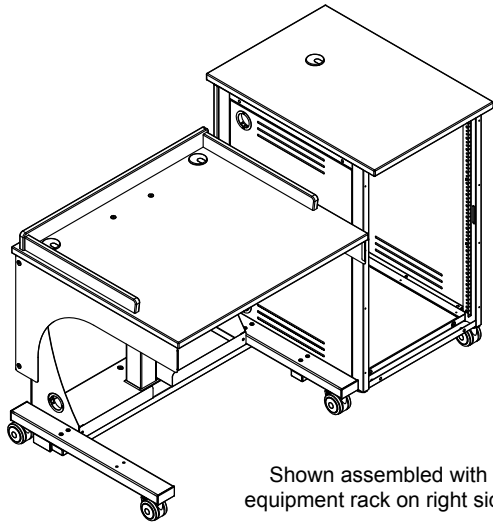

Shown assembled with
equipment rack on right side

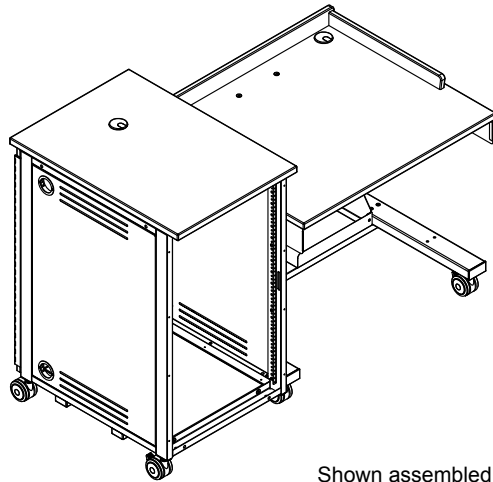

Shown assembled with
equipment rack on left side

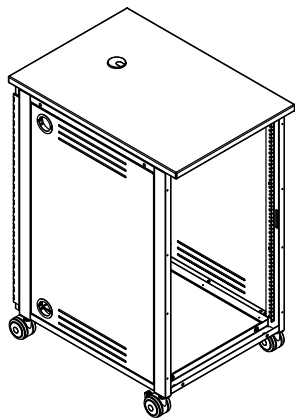

**Equipment rack
55366**

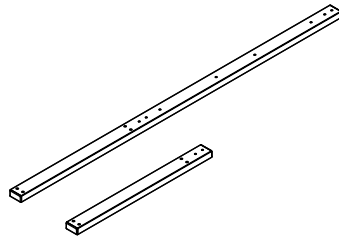

**Unit-to-unit connector kit
55367**

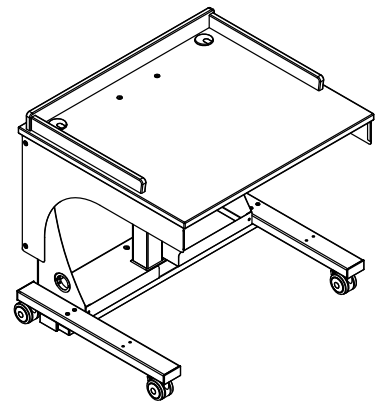

**Freedom One Lectern
55368**

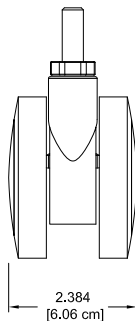
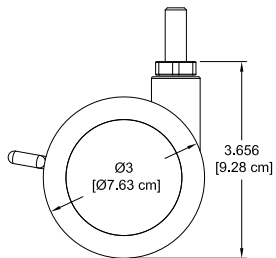
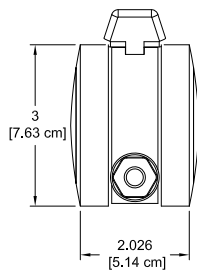
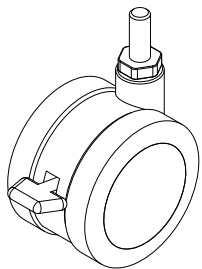

**3" Twin-Wheel caster
(TW)**

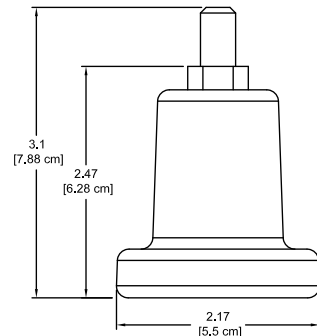
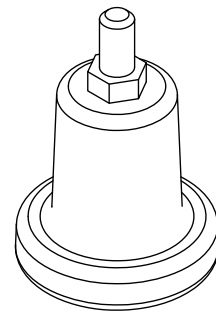

3" Bell Glide (G)

Note: Casters are made of
"soft thermoplastic".

Freedom One Lectern
 (Right-assembled with TW casters)

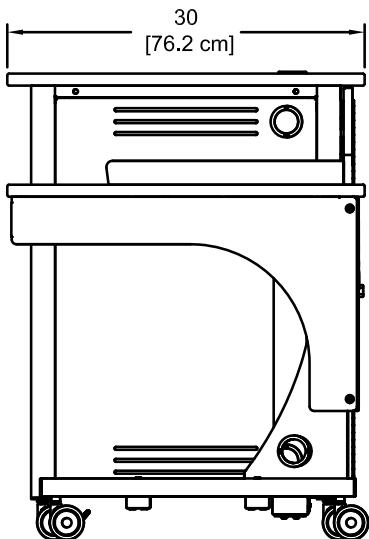
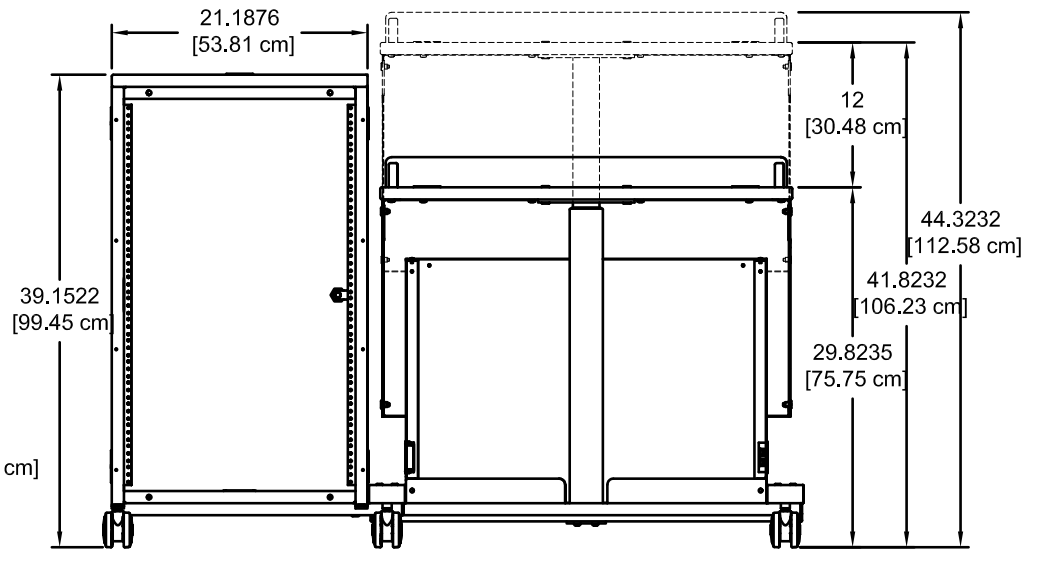
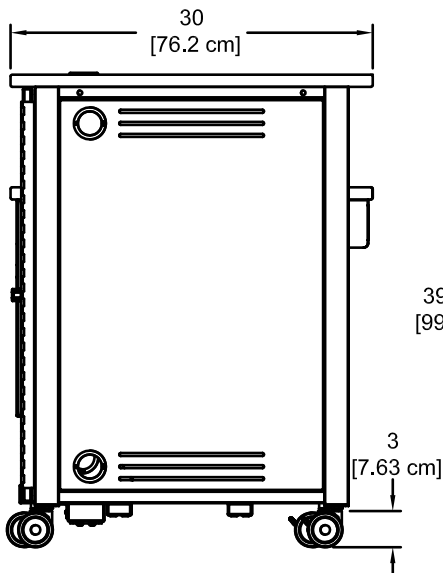
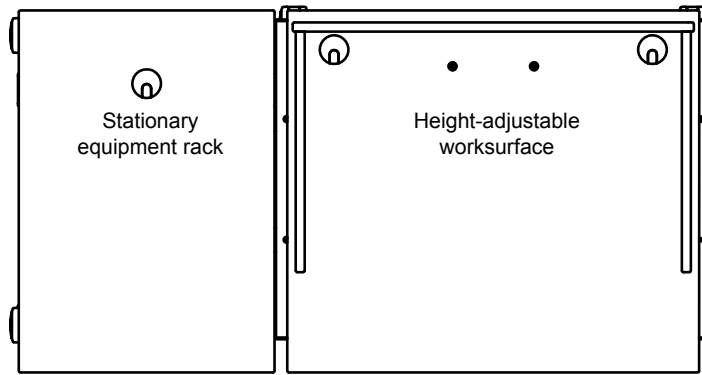

Adjustable worksurface side view

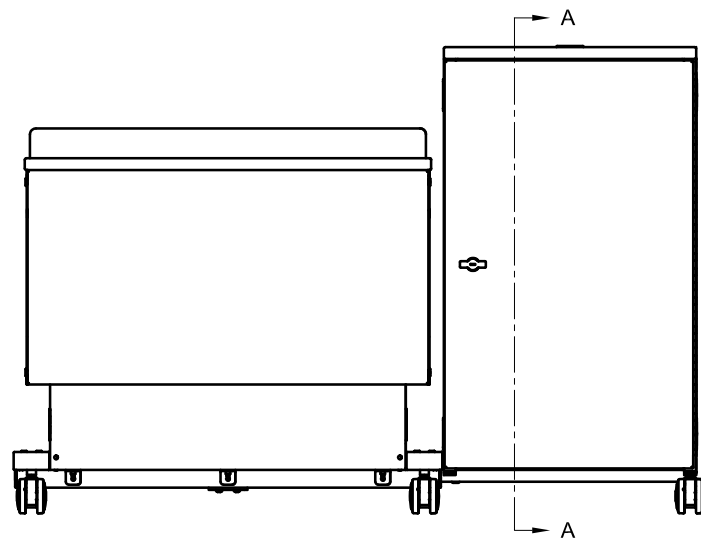

Audience side view

Equipment rack
Section view A-A

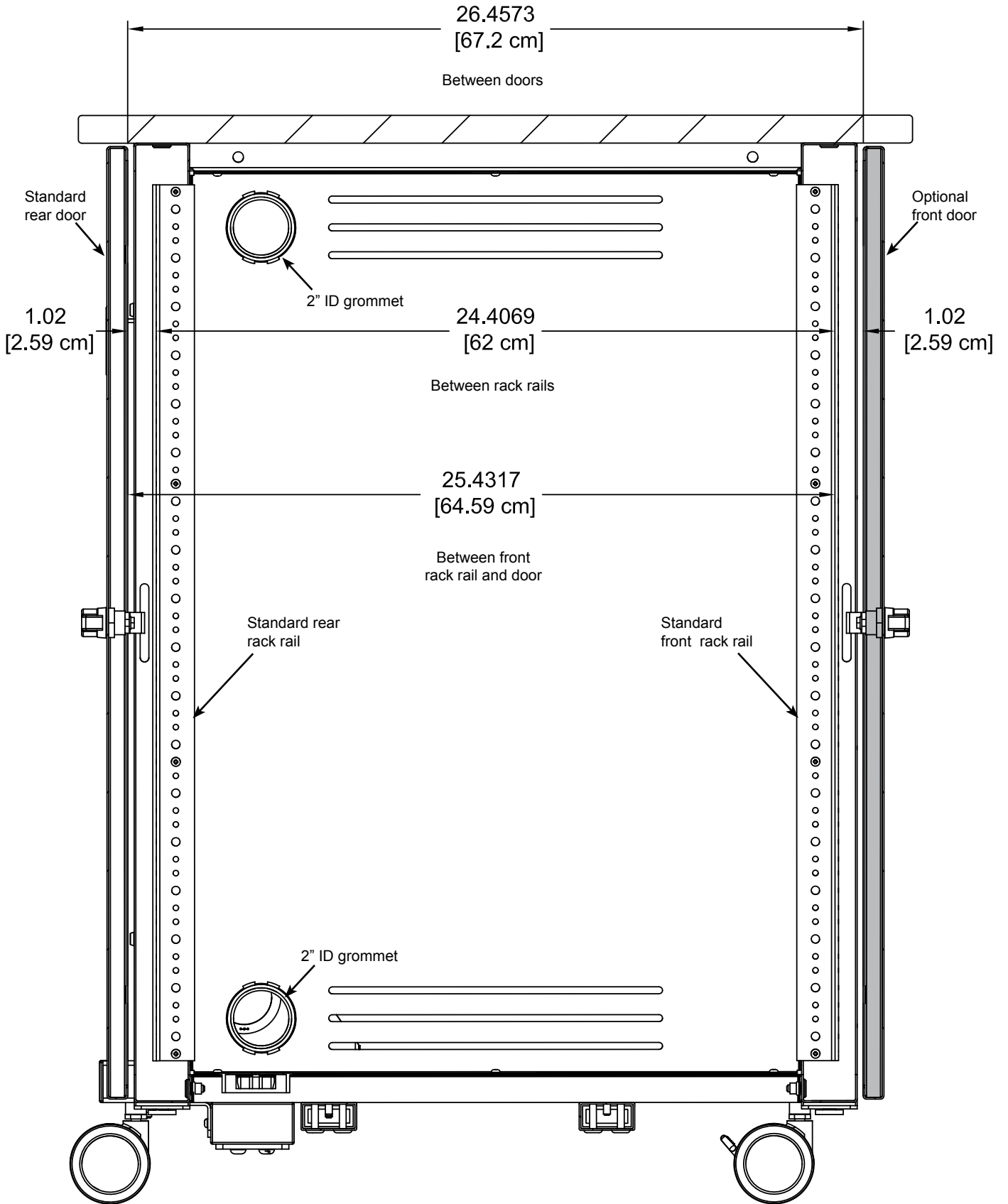

Note: Modified worksurface cutouts should be reviewed by Spectrum to ensure clearance of brackets, keyboard slides, or other objects under the worksurface. The weight of installed components should also be considered.

Available cutout areas
(no keyboard tray)

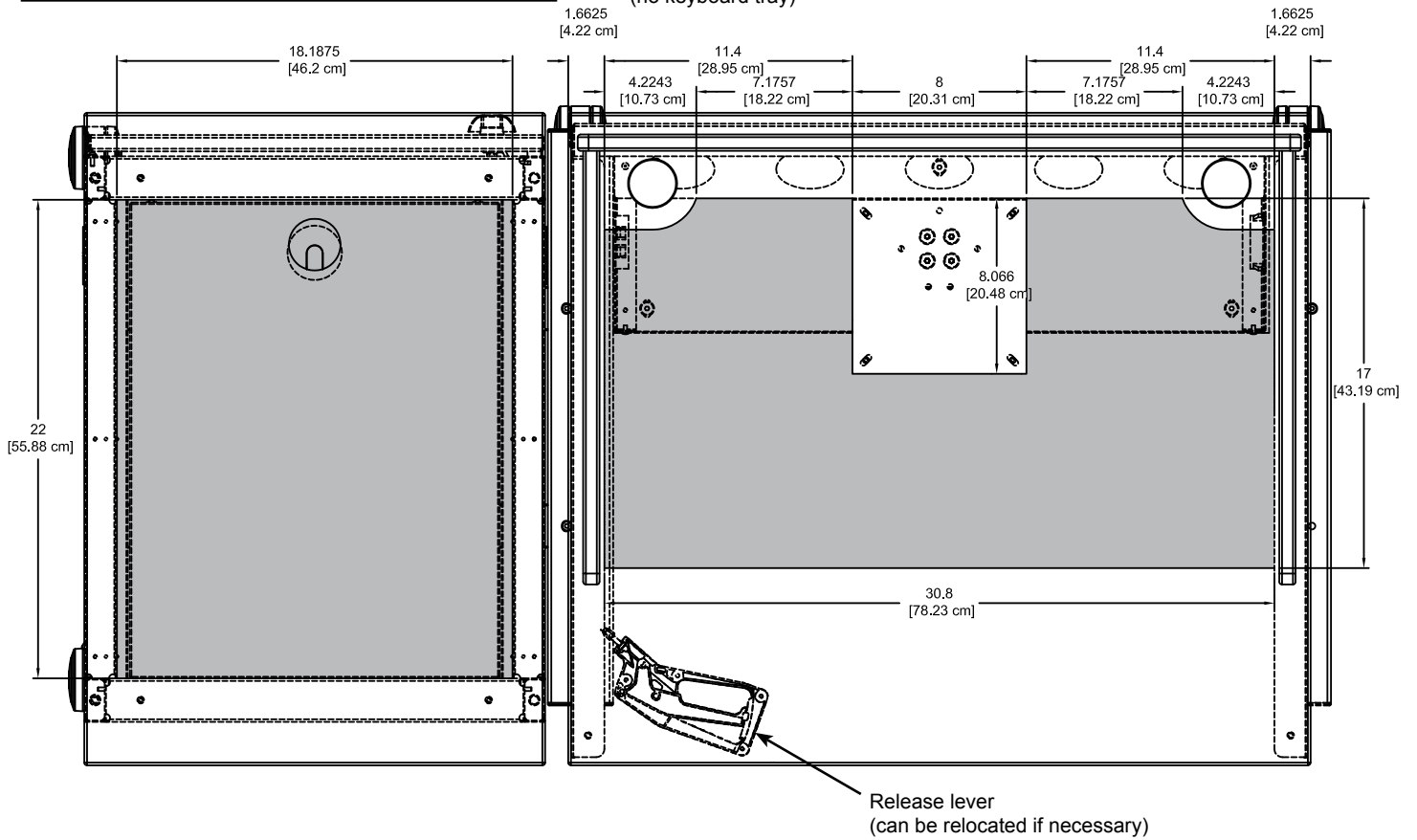

Available cutout areas
(with keyboard tray)

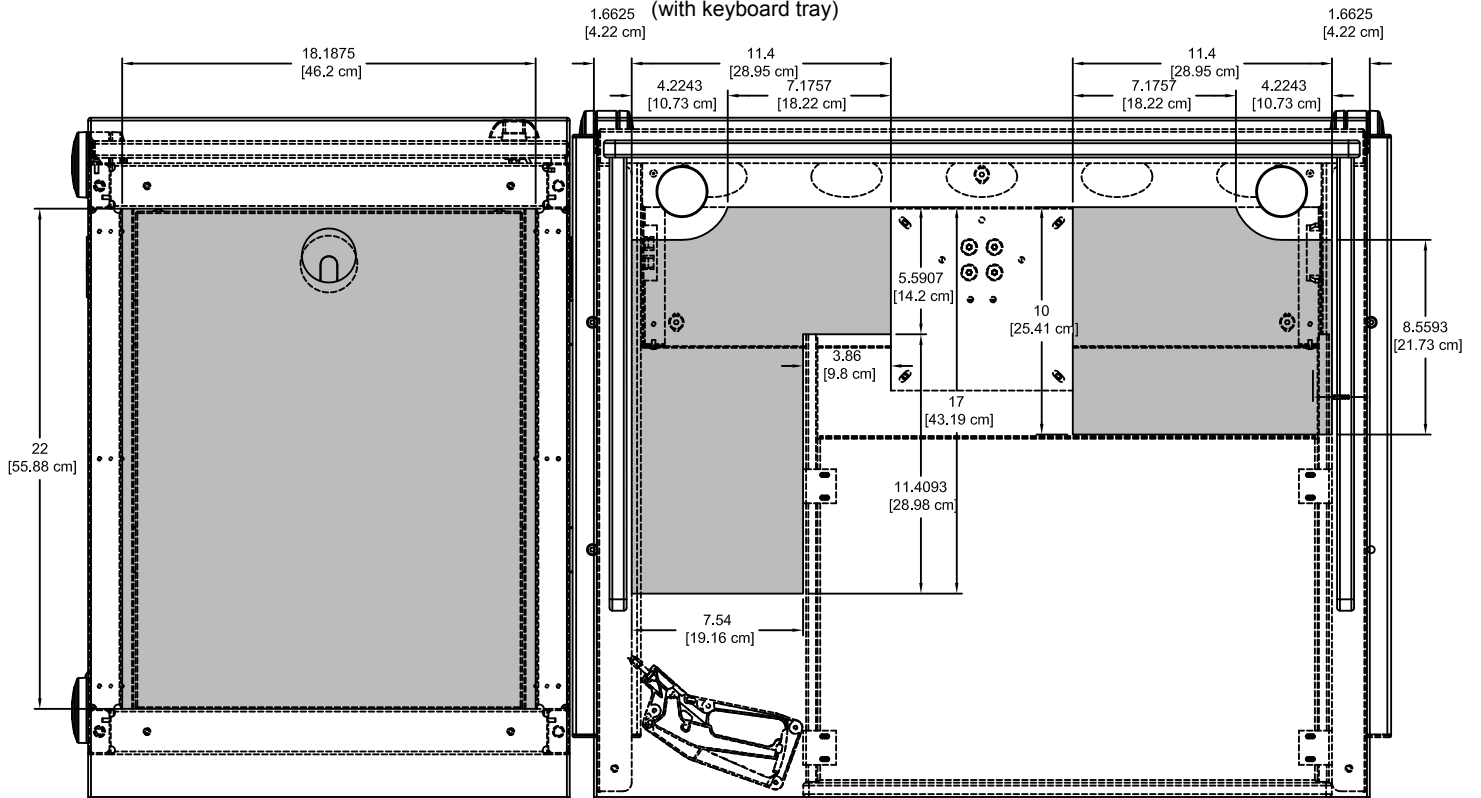

Accessories

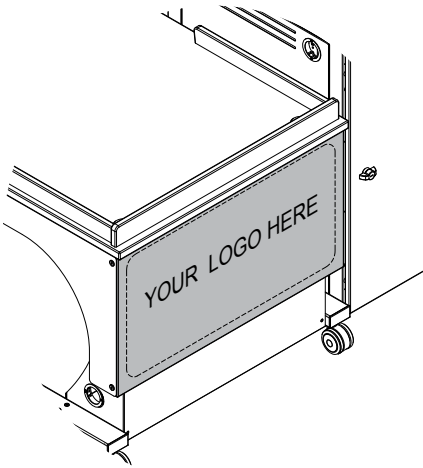

Customized modesty panel with logo for Freedom One Lectern

- To get a customized logo panel, contact Spectrum to specify all logo details
- New logos require a first time logo charge

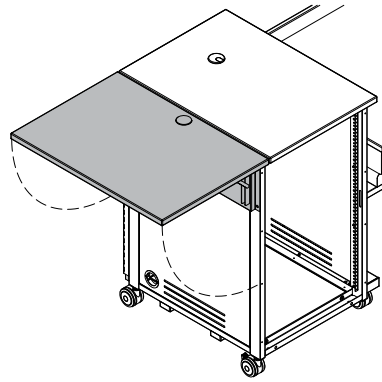

Note: Not recommended for use on stand-alone equipment racks.

Flip-up Shelf - 68204

- Shelf hinges lock into place in the upright position
- Includes 2" grommet
- Mounts on left or right
- Available in matching, or White Chalk Dry Erase laminate
- Mounting plate available in black or dark gray

Dimensions: 21.1875"W [53.8 cm] x 30"D [76.2 cm] x 1"H [2.54 cm]
 Weight capacity: 50 lb [22.7 kg]
 Shipping weight: 15 lb [6.8 kg]

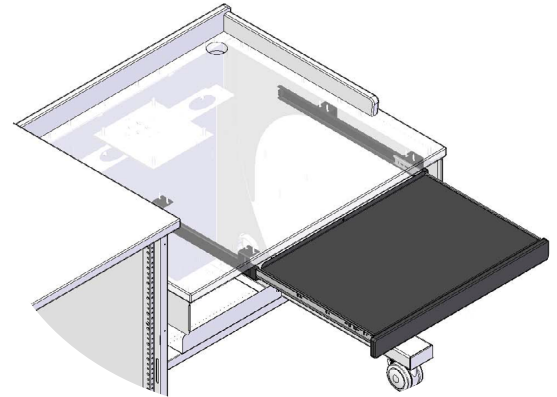

Keyboard Tray - 55356

22"W [55.9 cm] x 15.1875"D [38.6 cm] x 1.1875"H [3 cm]

Note: Worksurface has predrilled holes to simplify mounting. See capacity section for worksurface weight info. (38 lb max weight on adjustable worksurface)

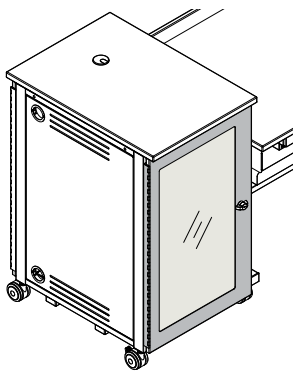

Clear Acrylic Locking Door 68153B 68153S

- Can be mounted to be hinged from the left or right side
- Available in black or silver sparkle

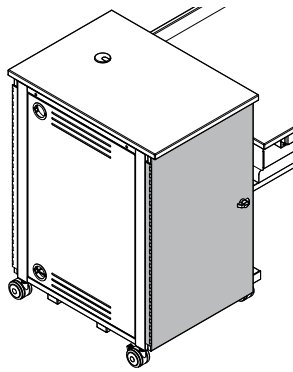

Solid Locking Door 68152B 68152S

- Can be mounted to be hinged from the left or right side
- Available in black or silver sparkle

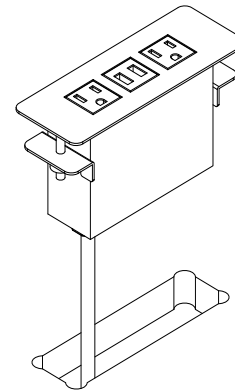

Power Module - 99058

- (2) AC power receptacles
- (2) USB charge ports
- Aluminum housing and flange
- Thumbscrew clamps
- Requires worksurface cutout
- ETL-certified
- Available in black, silver, or white
- Customer-installed

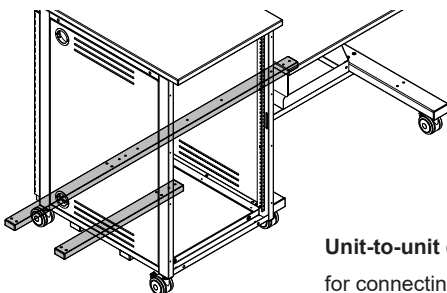

Unit-to-unit connector kit - 55367

for connecting equipment rack to lectern (available in black or silver sparkle)

Product update
 New USB-C Power Module version available. See details at:
www.spectrumfurniture.com

Rack-mount Accessories

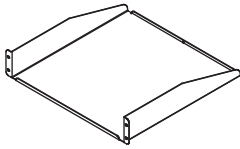

Cantilever Shelf - 2RU - 97504

- 16ga steel
- Shelf: 17.5"W [44.45 cm] x 18"D [45.7 cm] x 3.5"H [8.89 cm]
- Weight capacity: 50 lb [22.7 kg]
- Shipping weight: 8.1 lb [3.7 kg]

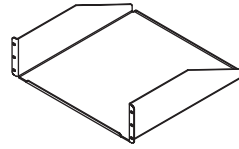

Cantilever Shelf - 3RU - 97502

- 16ga steel
- Shelf: 17.5"W [44.45 cm] x 18"D [45.7 cm] x 5.25"H [13.33 cm]
- Weight capacity: 80 lb [36.3 kg]
- Shipping weight: 9.2 lb [4.2 kg]

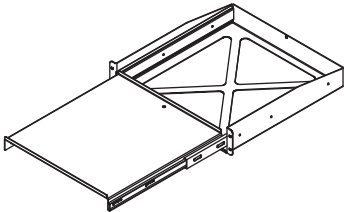

Pull-Out Shelf - 2RU - 97505

- 16ga steel
- 17.09"W [43.42 cm] x 18.12"D [46.03 cm] x 3.5"H [8.89 cm]
- Weight capacity: 50 lb [22.7 kg]
- Shipping weight: 15.6 lb [7.1 kg]

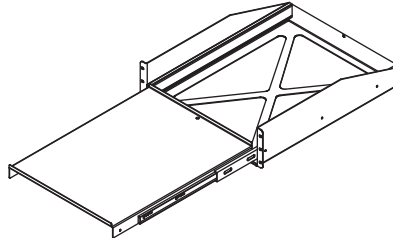

Pull-Out Shelf - 3RU - 97503

- 16ga steel
- 17.09"W [43.42 cm] x 22.11"D [56.14 cm] x 5.25"H [13.33 cm]
- Weight capacity: 80 lb [36.3 kg]
- Shipping weight: 18.5 lb [8.4 kg]

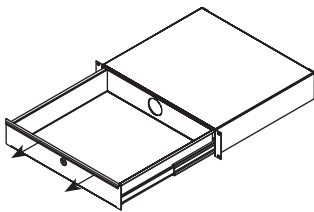

Locking Drawer - 2RU - 97527

- 16ga steel
- Drawer: 15.97"W [40.56 cm] x 14.56"D [36.98 cm] x 3"H [7.63 cm]
- Weight capacity: 50 lb [22.7 kg]
- Shipping weight: 15.85 lb [7.2 kg]

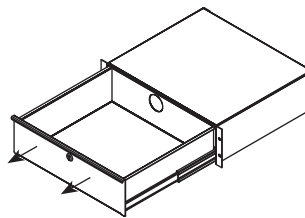

Locking Drawer - 3RU - 97526

- 16ga steel
- Drawer: 15.97"W [40.56 cm] x 14.56"D [36.98 cm] x 5.25"H [13.33 cm]
- Weight capacity: 50 lb [22.7 kg]
- Shipping weight: 18.5 lb [8.4 kg]

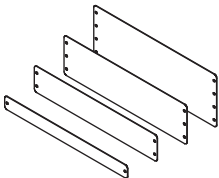

Rack-Mount Blanks

1RU - 97510 3RU - 97512
2RU - 97511 4RU - 97513

- Fills rack spaces where components are not needed
- 16 ga steel
- Shipping weight: <1 lb [45 kg]

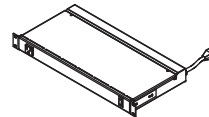

9-Outlet Power Strip - 1RU - 99021



- 8 outlets rear (breaker-protected)
- 1 convenience outlet front
- 115VAC, 60 Hz, 15 amps max
- 9' power cord
- Front LED power switch
- Enhanced surge protection
- ETL-listed, UL-listed
- 19"W [48.27 cm] x 9.25"D [23.5 cm] x 1.74"H [4.41 cm]
- Shipping weight: 8.7 lb [3.9 kg]

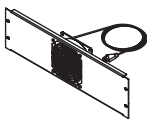

Single Fan - 3RU - 97507

- 50 cfm
- 120V~50/60 Hz, 15/13W
- RoHS
- 19"W [48.27 cm] x 1.56"D [3.97 cm] x 5.25"H [13.33 cm]
- Shipping weight: 3.78 lb [1.7 kg]

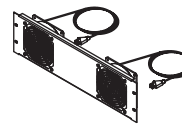

Double Fan - 3RU - 97506

- 100 cfm
- 120V~50/60 Hz, 15/13W
- RoHS
- 19"W [48.27 cm] x 1.56"D [3.97 cm] x 5.25"H [13.33 cm]
- Shipping weight: 5.47 lb [2.5 kg]



Wire Lace Kit - 95517

- Provides wire management
- Mounts to standard rack rails
- Includes (3) lace straps and mounting screws
- Includes (12) 5.5" zip ties
- Shipping weight: 1.25 lb [.57 kg]

See spectrumfurniture.com for the latest accessories and detailed warranty information.

Warranty

We will make it right for you!

Thanks for choosing Spectrum! Spectrum is committed to provide complete customer satisfaction. Each of our products is manufactured from the best materials available and each product is stringently monitored throughout the production process through our P.A.C.E. program (Product Assurance to meet Customer Expectations).

We expressly warrant that Spectrum products will be of good quality and workmanship and free from defect for the period set out in the warranty from the date of delivery.

For a listing of all product specific warranty terms please visit our website at:

<https://www.spectrumfurniture.com/en/resources/purchasing-terms-warranty>

1-800-235-1262

Toll-free HELPLINE

spectrum@spectrumfurniture.com