

**Technical Specifications**

55260	Standard Media Director V2
55259	with Overbridge Control Console™ (also requires 96507 insert panel)

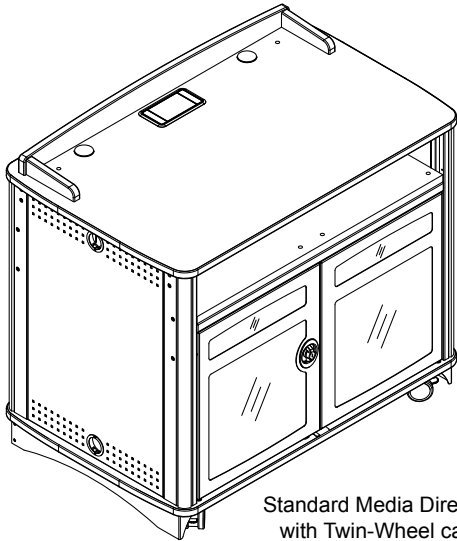

Standard Media Director V2  
with Twin-Wheel casters  
55260TW

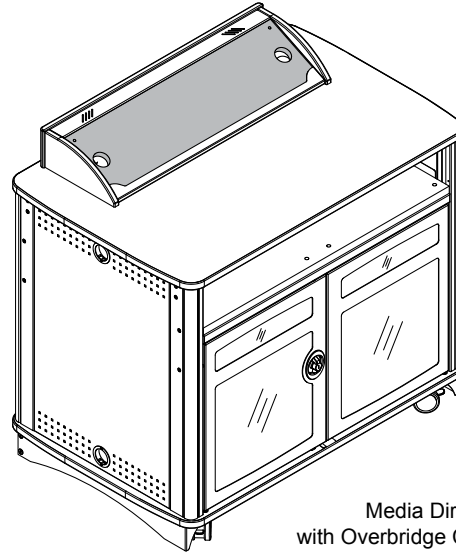

Media Director V2  
with Overbridge Control Console  
and Twin-Wheel casters  
55259TW  
shown with optional insert panel (shaded)

Spectrum's Media Director is designed to simplify the use and integration of a multi media lectern. We've designed the Media Director so that integrating podium lecterns couldn't be easier. A total of 52 rack units of rack rail are easily accessible from both front and rear to offer flexibility for the audiovisual setup of your choice. Quick-release doors and coordinated pass-through grommets simplify integration even further. Need to use monitor arms or a power/communication module? The Media Director includes standard cutouts on the worksurface for 2 arms and 1 module that double as grommets when not used. Overbridge models use an overbridge console specifically for the installation of training and presentation controls. Don't limit your integration potential – let the Media Director help you achieve your AV goals.

**Features and Benefits**

- Front and rear rack-rail equipment mounting simplifies installation for any equipment configuration with enough space for an internal CPU
- Standard rack rail brackets allow the front and rear rack rails to be moved further inside the unit, if necessary, to accommodate larger knobs and plugs
- Double-bolt, keyed locking front and rear doors provide security and easy-access
- Blank overbridge console version allows custom cutouts and installation of presentation controllers
- 3" swivel locking Twin-Wheel (TW) casters, and Toe Kick (TK) versions available
- Quick-release door hinges allow doors to be removed for full-access
- Removable acrylic viewing / access panel on the front door provides easy monitoring and access to internal equipment
- Ventilated side panels keep equipment cool
- Audience-side vented openings provide enhanced sound quality when speakers are installed
- Scratch and impact resistant 1.063" high-pressure laminate worksurface
- One rectangular worksurface grommet provides cable access or the ability to mount a power / communication module (standard version only)
- Two 2" cable grommets (left and right) on the worksurface or overbridge provide cable access
- Cable grommets throughout the unit keep wires and cords manageable
- Removable acrylic viewing / access panels on the front doors provide easy monitoring and access to internal equipment
- With enough storage space for an internal CPU, left or right-mountable rack-rail simplifies installation for any equipment configuration
- Pre-drilled left and right monitor arm mounting holes allow easy installation of a monitor arm
- Quick-change logo panel simplifies adding or changing logos
- Optional adjustable-height, flip-up shelf provides a convenient additional worksurface
- Optional steel handle provides easy mobility
- Wide variety of options and accessories allow unit to be configured to most situations
- Warranted to be free of all defects in materials and workmanship with a 10-year warranty

<b>Base Options</b>
TW - 3" Twin-Wheel casters TK - Toe Kick

<b>Options</b>
Page 9

**Color Options**

Standard laminate / color combinations

Wild Cherry / Black (CHB)	
Indigo Organix / Black (IB)	
Indigo Organix / Dark Gray (ID)	
Fusion Maple / Black (FMB)	

Standard color combination refers to the quickest deliverable product color combination. Custom laminates and color combinations are available-additional lead-times and up-charges may apply. Call 1-800-235-1262 for further information.

# Construction

- The worksurface, mid, and base panels are constructed from 1.063" thick NAUF (No Added Urea Formaldehyde) composite board with .030" high-pressure laminate on one face, and a balancing phenolic backer on the opposing face
- Metal components consist of 16-gauge and 20-gauge steel
- 16-gauge steel doors and corner columns
- Worksurface edges are covered with 3mm vinyl
- All metal components are finished with a scratch-resistant powder coat epoxy
- Solid wood corner trim
- Each Media Director V2 Lectern is factory-assembled with casters, packaged, and shipped on its own skid

# Specifications

Total internal area (mid section)	39.625"W x 27.75"D x 6.375"H
Total internal area (lower section)	39.625"W x 27.25"D x 24.9375"H
CPU area	12"W x 25"D
Standard rack rail	52RU (four sets of 13RU)
3" Twin-Wheel casters	weight capacity 165 lbs each
Optional flip-up shelf	23"W x 27.75"D x 1" thick, can support a maximum of 50 lbs. Shelf hinges lock into place in the upright position, Adjustable height
Worksurface grommet	7.25"W x 3.875"D
Available cutout area in blank overbridge panel	26.25"W x 8.1875"D
Unit weights (nominal)	254 lbs - with casters and surround 274 lbs - with toe kick and surround 235 lbs - with overbridge
Shipping weights (nominal)	334 lbs - with casters and surround 354 lbs - with toe kick and surround 315 lbs - with overbridge
Meets or exceeds applicable ANSI-BIFMA test standards	

Specifications subject to change without notice

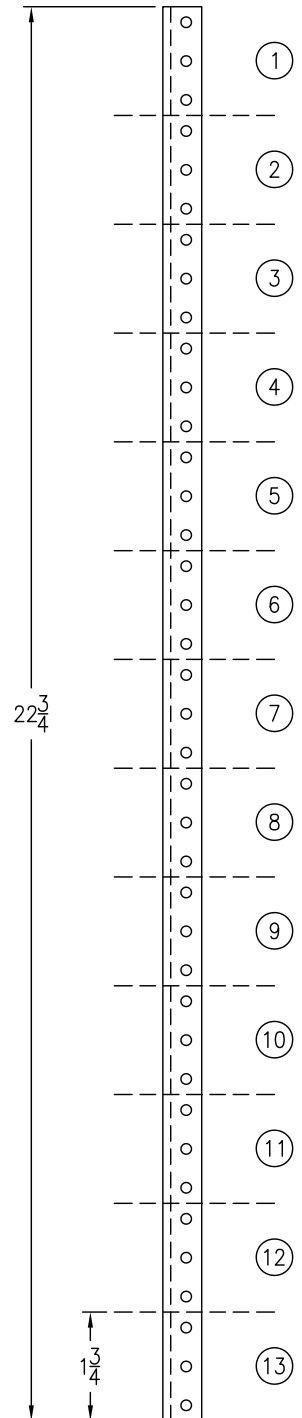
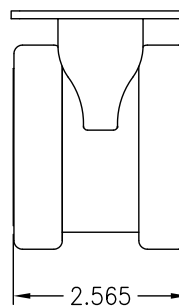
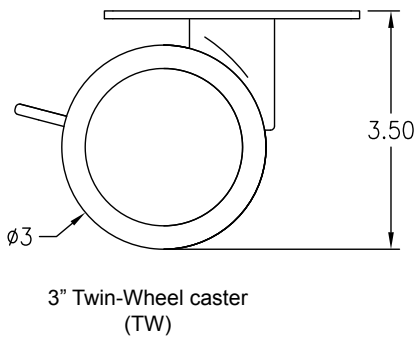

13RU available

# Models

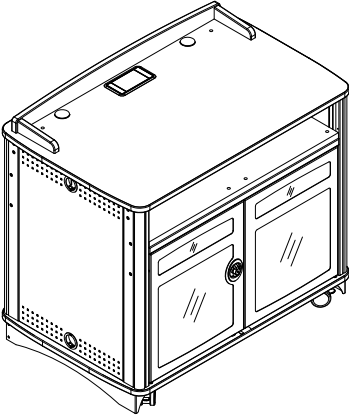
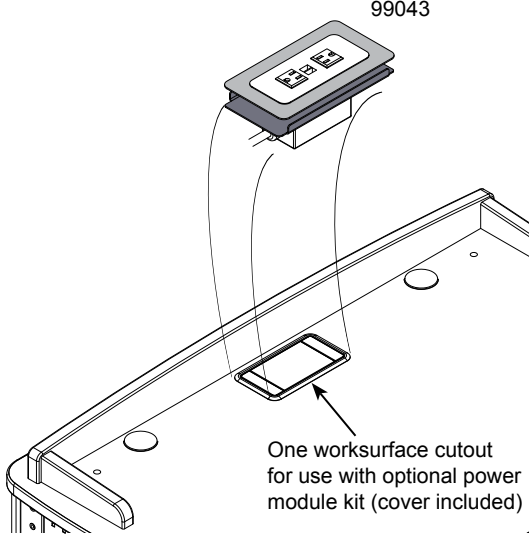
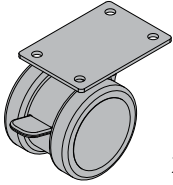
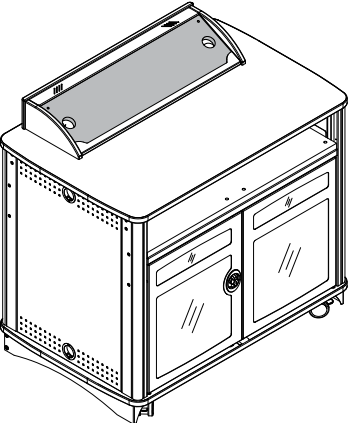
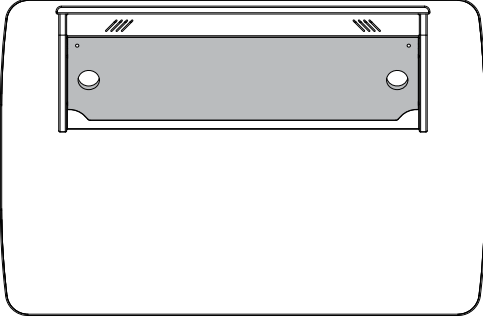
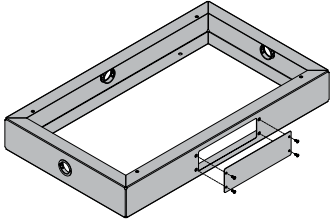
	Worksurface:	Base Options:
<p data-bbox="219 289 461 315"><b>Standard MDV2 Lectern</b></p>  <p data-bbox="461 1079 586 1115"><b>55260</b></p>	 <p data-bbox="980 390 1040 415">99043</p> <p data-bbox="873 827 1133 905">One worksurface cutout for use with optional power module kit (cover included)</p> <p data-bbox="602 953 1127 1083">Surround with one worksurface cutout and cover for use with optional power module (not included). Includes two 2" grommet holes with covers for routing cords from worksurface, and two .375" holes with plugs for optional monitor arm mounting.</p>	 <p data-bbox="1386 726 1422 751">X 4</p> <p data-bbox="1208 779 1479 804">(TW) 3" Twin-Wheel casters</p>
<p data-bbox="175 1142 509 1192"><b>MDV2 Lectern with Overbridge Control Console</b></p>  <p data-bbox="131 1709 553 1829">Note: The insert panel shown (<i>shaded</i>) is <u>not</u> included with the lectern or overbridge. This option needs to be ordered separately to complete the overbridge.</p> <p data-bbox="461 1885 586 1919"><b>55259</b></p>	 <p data-bbox="602 1730 1127 1808">Overbridge with blank insert panel for custom cutouts (see p.8 for dimensions). Overbridge is not available separately. Includes two 2" grommet holes with covers.</p>	 <p data-bbox="1227 1493 1451 1518">(TK) Standard Toe Kick</p>

Media Director V2 with TW casters and surround  
 (shown with optional handle, flip-up shelf, pull-  
 out drawer, and adjustable keyboard tray)

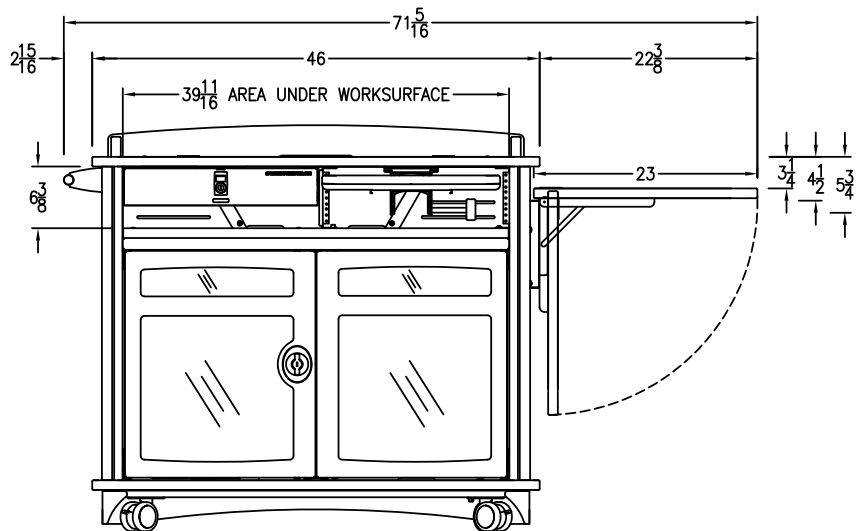
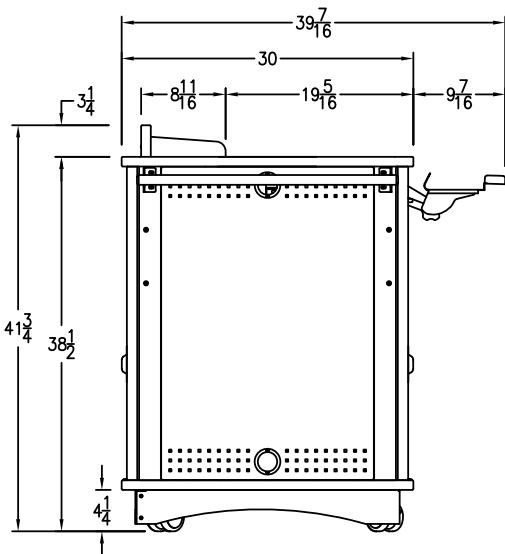
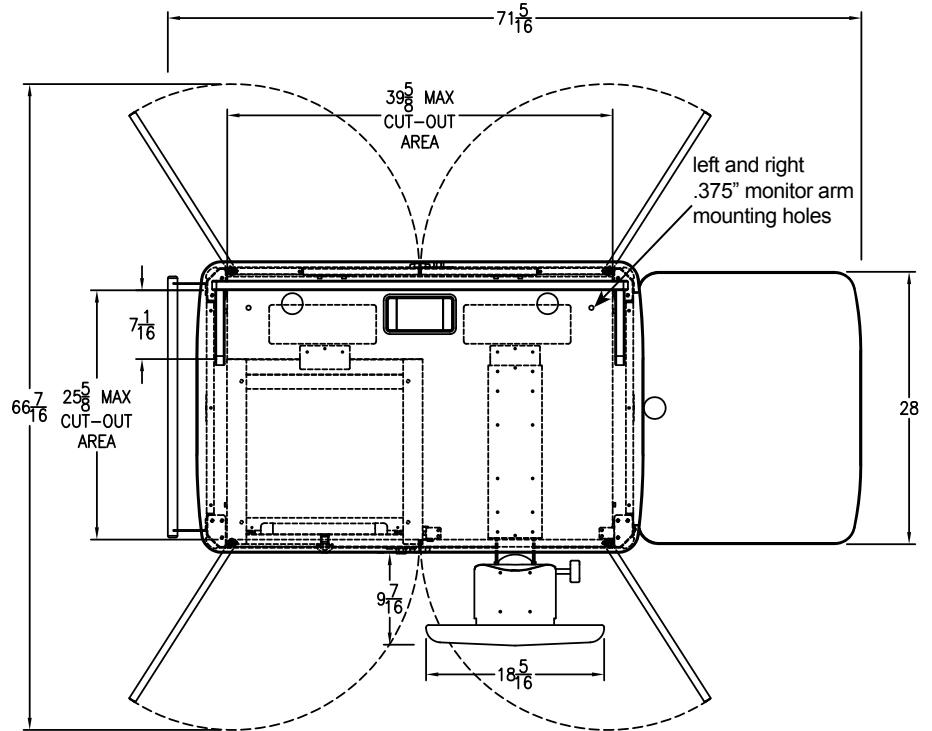
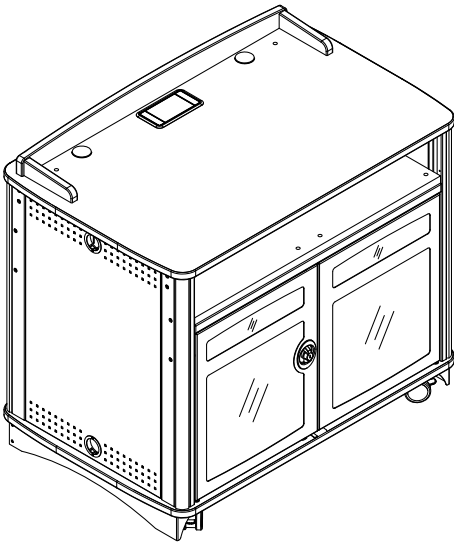

Note: Modified worksurface cutouts should be reviewed by Spectrum to ensure clearance of brackets, keyboard slides, or other objects under the worksurface.

Media Director V2 with Toe Kick and surround  
(shown with optional keyboard tray)

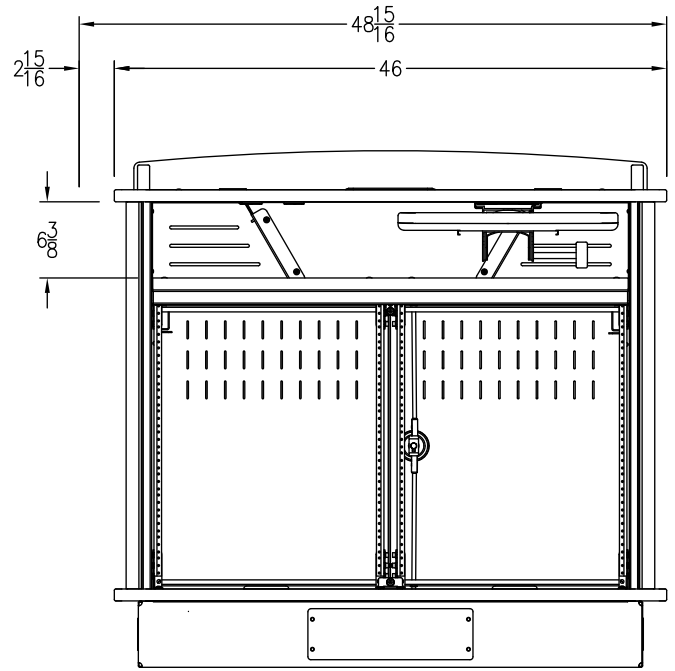
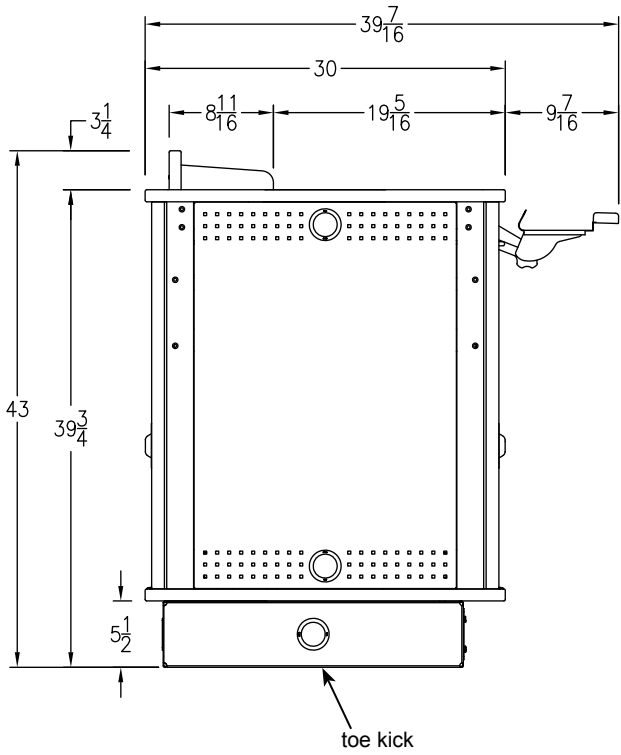

(shown with doors removed)

all Media Director Lecterns include  
two mid-panel cutouts measuring  
11"W x 4"D to rack rail area below

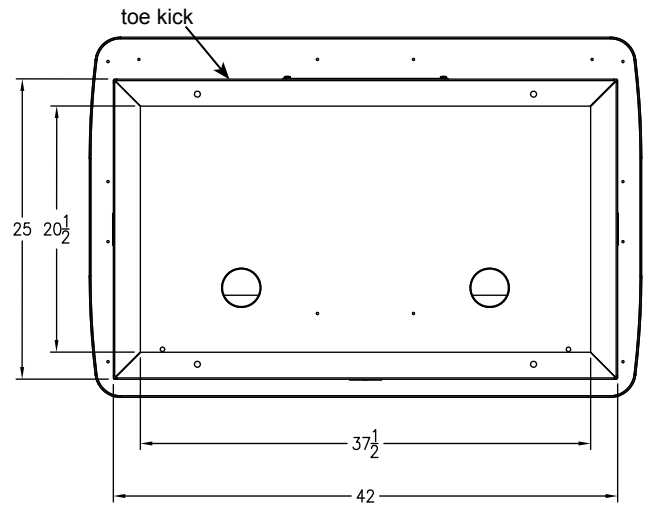
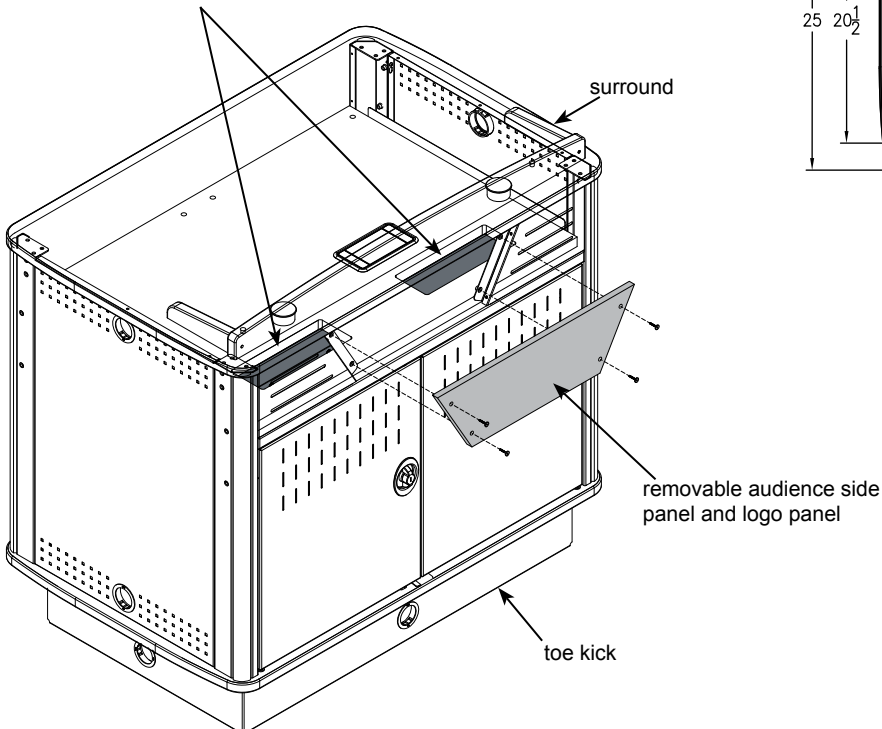

bottom view

Media Director V2  
section view

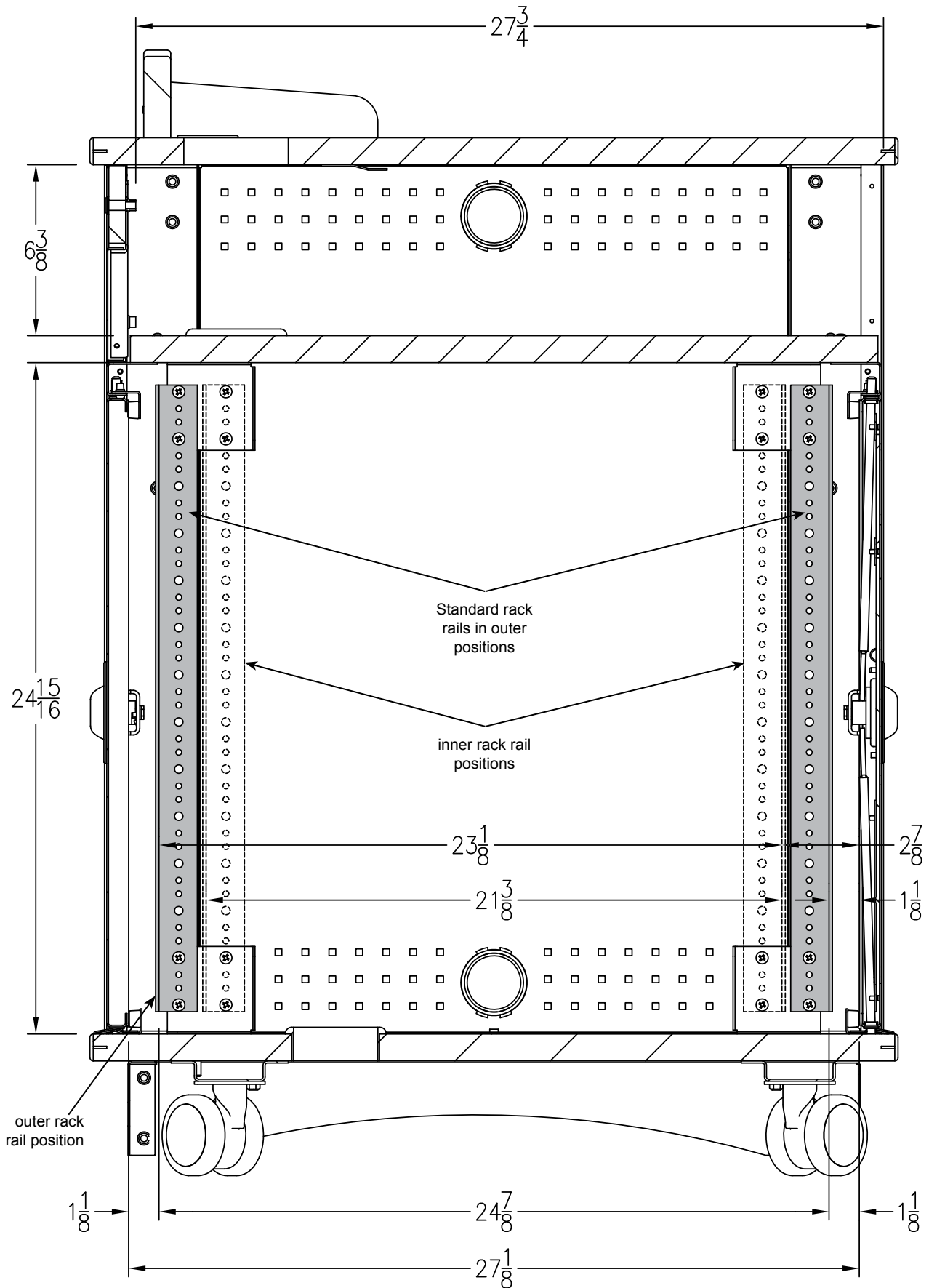

Media Director V2 with Overbridge  
Control Console and twin wheels

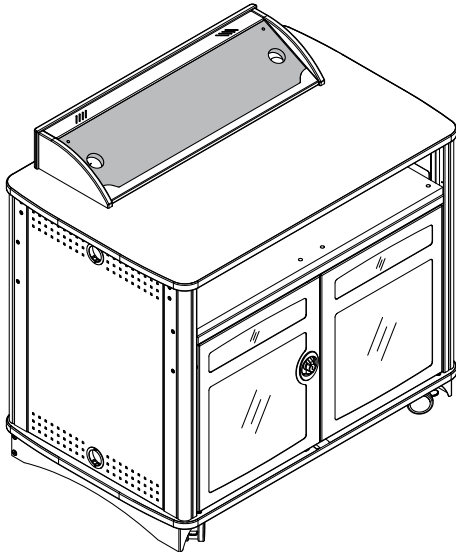

Note: The insert panel shown (*shaded*) is not included with the lectern or overbridge. This option needs to be ordered separately to complete the overbridge.

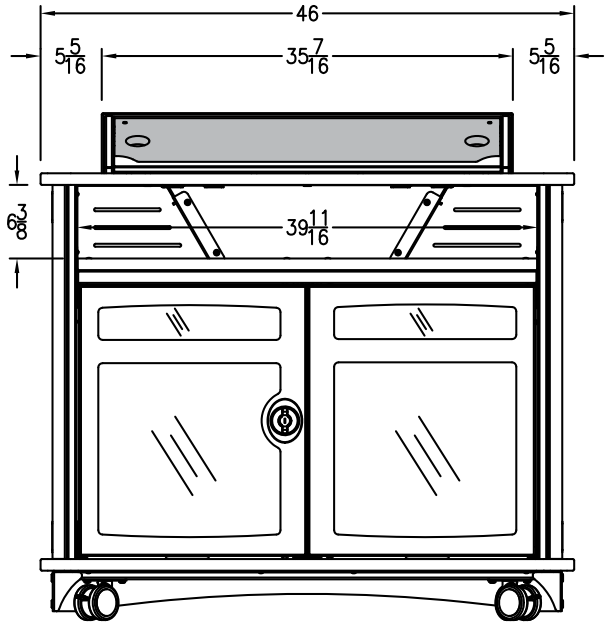
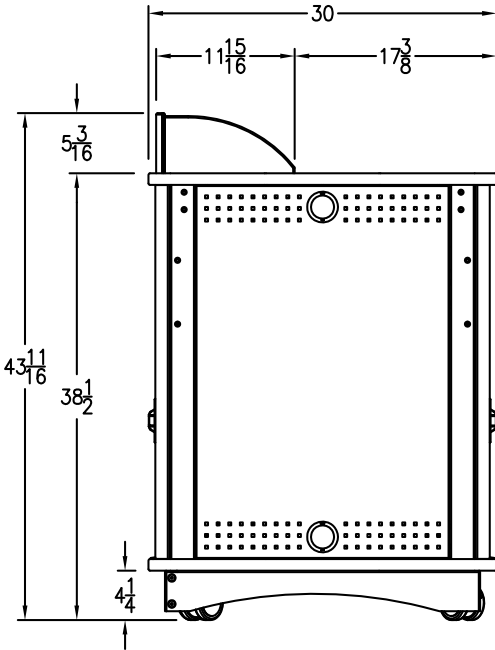
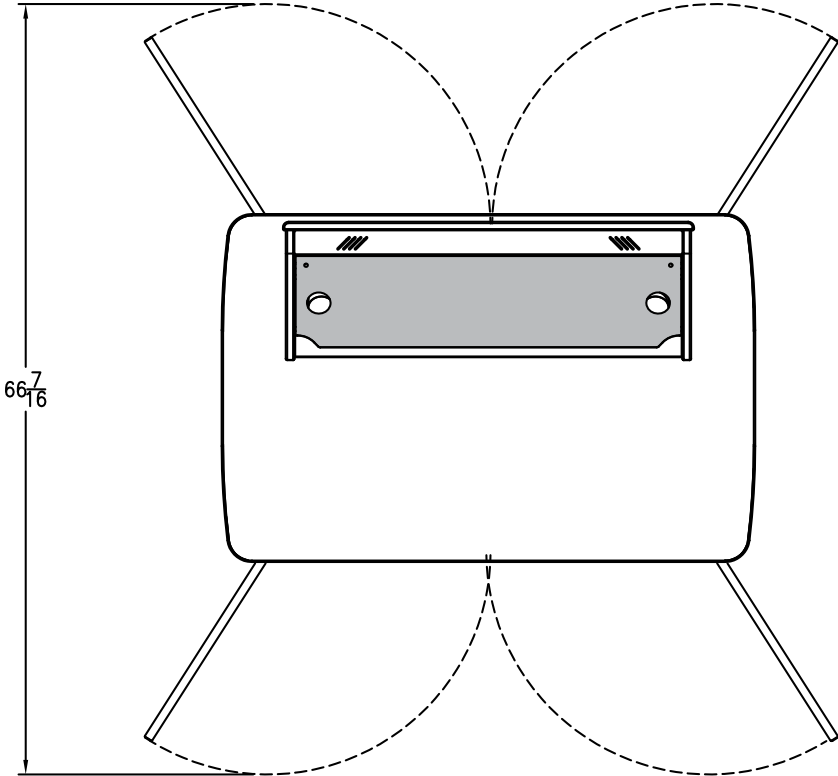

Media Director V2 overbridge panel blank  
(flat view)

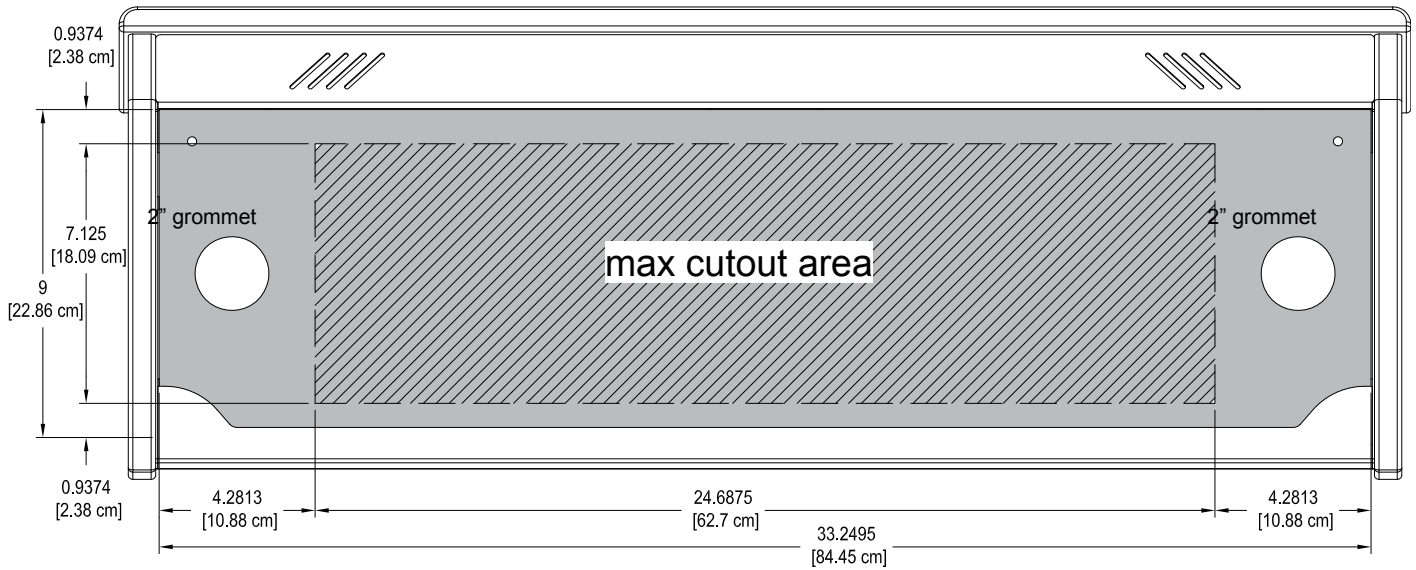

Note: The Overbridge Control Console™ has been designed for many of the currently available controllers on the market, however, modified cutouts should be reviewed by Spectrum to ensure clearance of brackets, keyboard slides, or other objects under the worksurface.

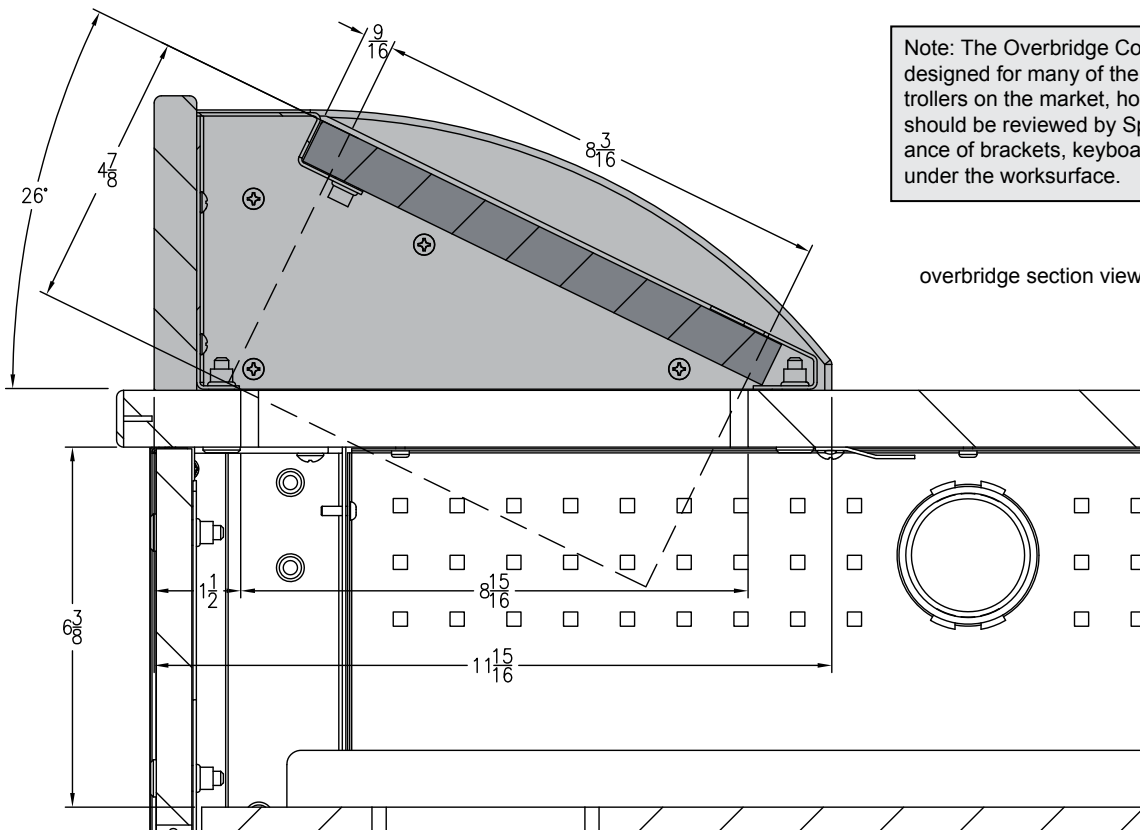

overbridge section view

Note: The insert panel shown (*shaded*) is not included with the lectern or overbridge. This option needs to be ordered separately to complete the overbridge. This insert panel is horizontally symmetrical and can be easily removed, rotated, and re-installed if a cutout needs to be relocated to the opposite side of the overbridge.

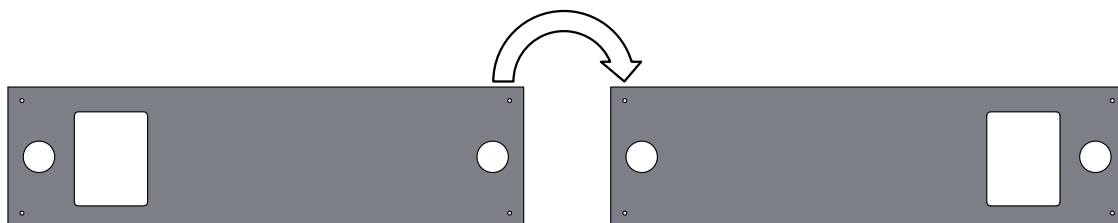



# Options

Note: The flip-up shelf and steel handle can be mounted on either side of the lectern. Both can be mounted on the same side, but the shelf needs to be mounted in a lower position to provide enough clearance for the handle.

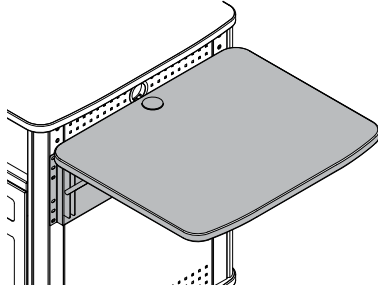

**Flip-Up Shelf**  
 (mounts on left or right side, max two per unit)  
 includes 2" grommet  
 23"W x 27.375"D  
 (50 lbs max capacity)  
 55263

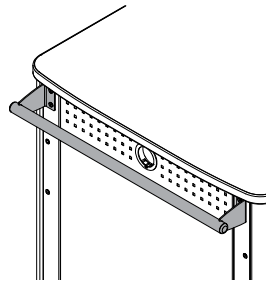

**Steel Handle**  
 (mounts on left or right side, max two per unit)  
 55265

Note: Power and communication wiring for document cameras, laptop computers, and/or projectors placed on the flip-up shelf should be routed on top of the audience-side of the shelf. Use of the shelf grommet hole for wiring will result in pinching of the cords when the shelf is folded.

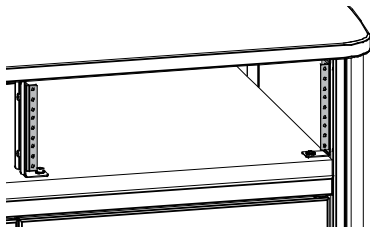

**Upper Rack Rail Kit (3RU)**  
 (max 2 per unit)  
 55266

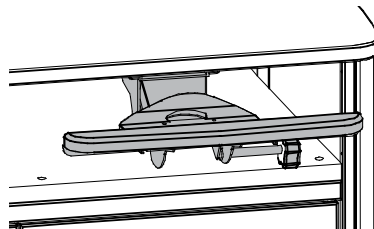

**Adjustable Econo Keyboard Tray**  
 18.375"W x 17.75"D  
 (max 2 per unit)  
 95520

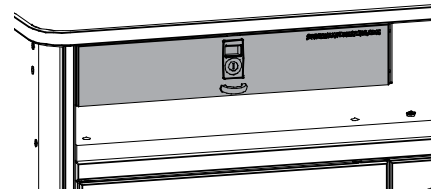

**Pull-Out Drawer**  
 18.813"W x 15.25"D x 3.125"H  
 (max 1 per unit)  
 55264

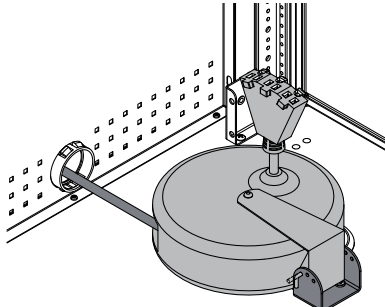

**Retractable Cord Reel**  
 15' [457.2 cm] retractable, 12 AWG, with breaker,  
 (mounts horizontally inside lectern to base  
 panel) 10 lbs [.45 kg]  
 99029



**UL  
LISTED**

Note: When installed, the optional cord reel takes up 3RU from the bottom of the rack rail.

**!** The cord reel is intended to provide temporary access to electrical outlets for Spectrum mobile lecterns. Check local electrical codes prior to installation.

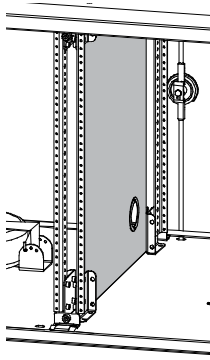

**Security Panel**  
55262

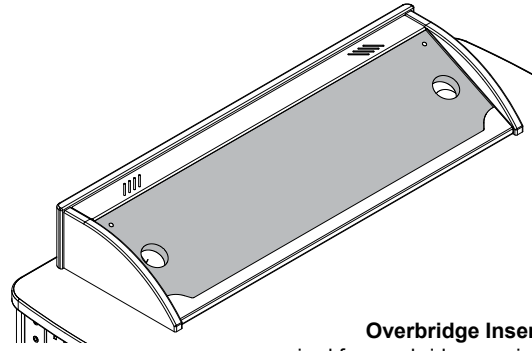

**Overbridge Insert Panel**  
required for overbridge version-contact Spectrum  
to specify cutout size(s) and position(s)  
overbridge not available separately  
96507 - blank panel  
96507mod - panel with cutout(s)

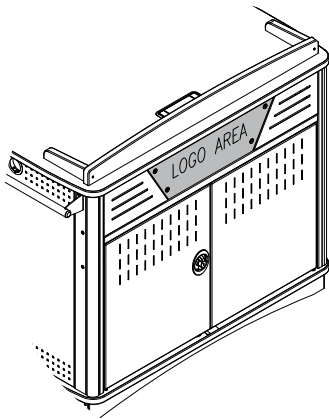

**Custom-Cut Logo Panel**  
(audience-side)  
55261

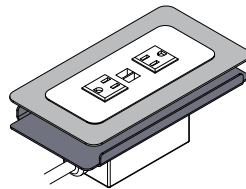

**Cove Power Module Kit  
with mounting plate**  
9' power cord, 2 AC outlets,  
2 USB charge ports  
7.5"W x 3.25"D x 4.25"H  
99043

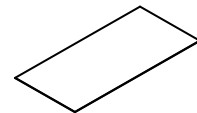

**Non-Slip CPU Pad**  
11"W x 23"D  
95518

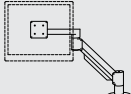

**Flat Panel Monitor Arms and Tablet Mounts**  
(See the Spectrum website or catalog for the latest available monitor arm and tablet mounting options)

# Rack-mount accessories

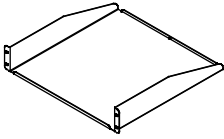

**Cantilever Shelf (2RU) - 97504**

- 17.5"W [44.5 cm] x 18"D [45.7 cm] x 3.5"H [8.9 cm]
- 50 lb [22.7 kg] max load
- Weight: 8.1 lb [3.7 kg]

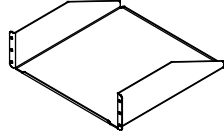

**Cantilever Shelf (3RU) - 97502**

- 17.5"W [44.5 cm] x 18"D [45.7 cm] x 5.25"H [13.3 cm]
- 80 lb [36.3 kg] max load
- Weight: 9.2 lb [4.2 kg]

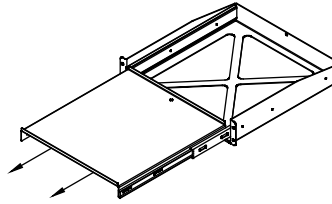

**Pull-Out Shelf (2RU) - 97505**

- 16.5"W [41.9 cm] x 17.75"D [45 cm]
- 50 lb [22.7 kg] max load
- Weight: 15.6 lb [7.1 kg]

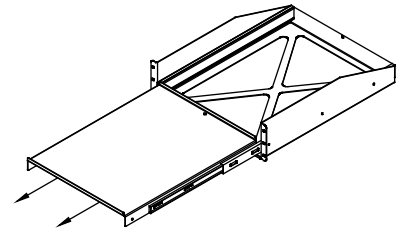

**Pull-Out Shelf (3RU) - 97503**

- 16.5"W [41.9 cm] x 21.75"D [55.2 cm]
- 80 lb [36.3 kg] max load
- Weight: 20.9 lb [9.5 kg]

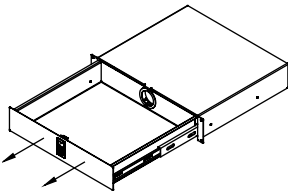

**Locking Drawer (2RU) - 97523**

- Interior dims: 15.75"W [40 cm] x 13.6875"D [34.8 cm] x 2.875"H [7.3 cm]
- 25 lb [11.4 kg] max load
- Weight: 15.85 lb [7.2 kg]

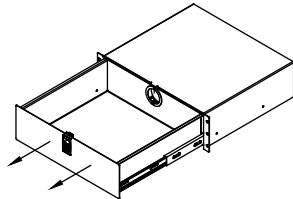

**Locking Drawer (3RU) - 97522**

- Interior dims: 15.9375"W [40.5 cm] x 14.5"D [36.8 cm] x 5.25"H [13.3cm]
- 50 lb [22.7 kg] max load
- Weight: 18.5 lb [8.4 kg]

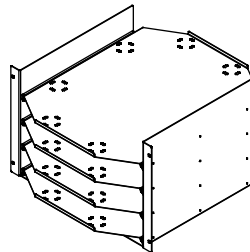

**LT-4 Laptop Storage Unit (7RU) - 97517**

- Stores 4 full-size laptops horizontally
- Laptop tray dims: 16.25"W [41.3 cm] x 20.5"D [52 cm] x 2.1875"H [5.6 cm]
- Weight: 29.8 lb [13.5 kg]

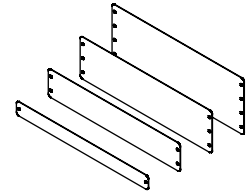

**Rack-Mount Blanks**

(fills rack spaces where components are not needed)

- 97510** - (1RU)
- 97511** - (2RU)
- 97512** - (3RU)
- 97513** - (4RU)

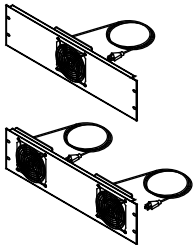

**Cooling Fans (3RU)**  
**97507 - Single Fan**  
**97506 - Double Fan**

- 19"W [48.3 cm] x 2"D [5.1 cm] x 5.25"H [13.3 cm]
- 97507 - Weight: 3.7 lb [1.7 kg]
- 97506 - Weight: 4.7 lb [2.1 kg]

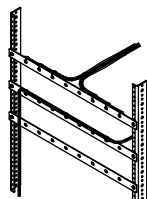

**Wire Lace Kit - 95517**

- 3 lace straps included
- Weight: 1.25 lb [.57 kg]

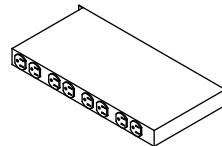

**9-Outlet Power Strip (1RU) - 99021**

- 19"W [48.3 cm] x 9"D [22.9 cm] x 1.75"H [4.4 cm]
- Weight: 8.7 lb [3.9 kg]

# Warranty

## WE WILL MAKE IT RIGHT FOR YOU!

Spectrum is committed to provide complete customer satisfaction. Each of our products is manufactured from the best materials available and each product is stringently monitored throughout the production process through our P.A.C.E. program (Product Assurance to meet Customer Expectations).

We expressly warrant that Spectrum products will be of good quality and workmanship and free from defect for the period set out in the warranty table below from the date of delivery. This warranty shall not apply to defects or damage resulting from misuse, abuse, neglect, improper care, modification or repair not authorized by Spectrum, or any other cause outside the control of Spectrum. Spectrum will, at its sole option, either repair or replace the defective product.

This warranty is exclusive; no other warranty, written or oral, is expressed or implied. This warranty is given by Spectrum to Buyer and to no other person or legal entity. No Spectrum dealer, distributor, agent or employee is authorized to make any modification or addition to this warranty.

**NOTWITHSTANDING ANYTHING TO THE CONTRARY, SPECTRUM WILL NOT UNDER ANY CIRCUMSTANCES BE LIABLE FOR INDIRECT OR LIQUIDATED DAMAGES, INCLUDING CONSEQUENTIAL, INCIDENTAL AND SPECIAL DAMAGES. IN NO EVENT SHALL SPECTRUM'S LIABILITY, WHETHER UNDER CONTRACT OR WARRANTY, IN TORT OR OTHERWISE, EXCEED THE PURCHASE PRICE RECEIVED BY SPECTRUM FOR THE PRODUCT AT ISSUE AND "RECALL ACTION" EXPENSES. SPECTRUM SHALL NOT BE SUBJECT TO ANY OTHER OBLIGATIONS OR LIABILITIES, WHETHER ARISING OUT OF BREACH OF CONTRACT, WARRANTY, TORT (INCLUDING NEGLIGENCE AND STRICT LIABILITY) OR OTHER THEORIES OF LAW, WITH RESPECT TO PRODUCTS SOLD OR SERVICES RENDERED BY SPECTRUM, OR ANY UNDERTAKINGS, ACTS OR OMISSIONS RELATING THERETO.**

Our Customer Service Department is ready to provide immediate attention to any questions, comments or concerns. They are available to answer your calls Monday through Friday from 7 am to 5 pm CST. In addition your product comments or concerns are welcome via e-mail at: [spectrum@spectrumfurniture.com](mailto:spectrum@spectrumfurniture.com).

Warranty Table

effective 1/1/2015

Item	Warranty Period
Adjustable Crank / Electric Desk Legs	• 1 Year
Flat Panel Desk Gas Cylinders	
Chairs <ul style="list-style-type: none"> <li>• Adjustable Height Chair Parts – including frames, gas cylinders, wood and plastic parts, control handles, casters</li> <li>• Adjustable Height Chair Upholstery</li> <li>• In-Stock Upholstery</li> <li>• Graded-In Fabrics and Customer Owned Material</li> </ul>	<ul style="list-style-type: none"> <li>• 7 Years</li> <li>• 2 Years</li> <li>• 2 Years</li> <li>• No Warranty</li> </ul>
Height Adjustable Columns and Lifts	• 1 Year
General Use Casters	
Electrical (including timers and LINAK actuators)	• 2 Years
Keyboard / Mouse Trays	• 1 Year
Flat Panel Monitor Arms <ul style="list-style-type: none"> <li>• Flat Panel Monitor Arm – General Parts</li> <li>• Flat Panel Monitor Arm – Gas Cylinders</li> </ul>	<ul style="list-style-type: none"> <li>• 5 Years</li> <li>• 2 Years</li> </ul>
Desks and Lecterns <ul style="list-style-type: none"> <li>• Computer Desk Chassis</li> <li>• Cart Chassis</li> <li>• Lectern Chassis</li> </ul>	• 10 Years

