

Assembly Instructions



Important

Before you begin, read and comply with all safety and operating instructions, and ensure all parts and correct quantities are included.

Any parts damaged during shipment must be reported within 5 days of receipt. To report information regarding missing parts or damage, to purchase parts or accessories, or if you have any questions, please contact us.

www.spectrumfurniture.com
800-235-1262, 715-723-6750

Thank you for purchasing Spectrum products!

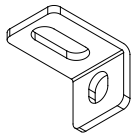

(2) 044069
Worksurface bracket

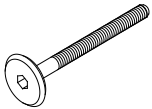

(2) 038047
1/4-20 x 50mm
JC bolt



(2) 0108896
1/4-20 Serrated
flanged locknut

Note: This kit attaches a worksurface of equal height to another worksurface above an equipment rack. (worksurfaces not included).

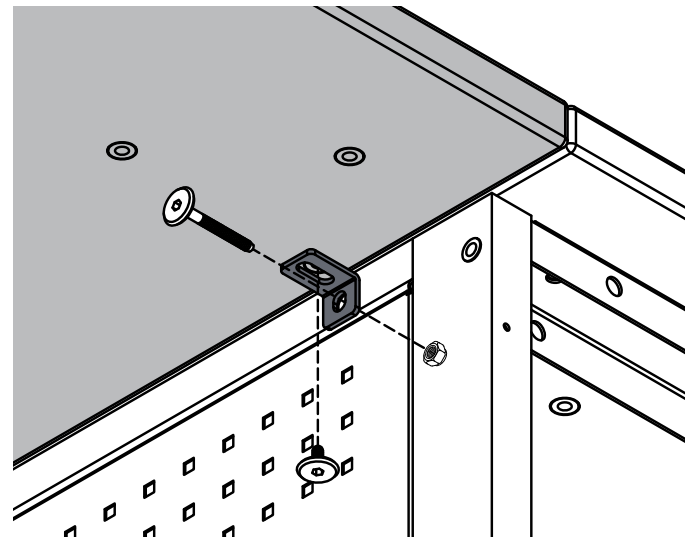

Level-height bracket kit for IMC 68207



Attach worksurface to equipment rack

1. Attach each worksurface bracket to the equipment rack with (1) 1/4-20 x 50mm JC bolt and (1) 1/4-20 serrated flanged locknut (*attached from inside eq rack*). (The slotted side of each bracket will attach to the worksurface.) Do not tighten completely. **Figure 1**.
2. Set the worksurface onto the assembled wall filler panel(s) and worksurface brackets and align the mounting holes.
3. Attach worksurface with 1/4-20 x 15mm JC bolts. (Worksurfaces and bolts not included).
4. Align the tops of the worksurfaces and tighten all screws securely.

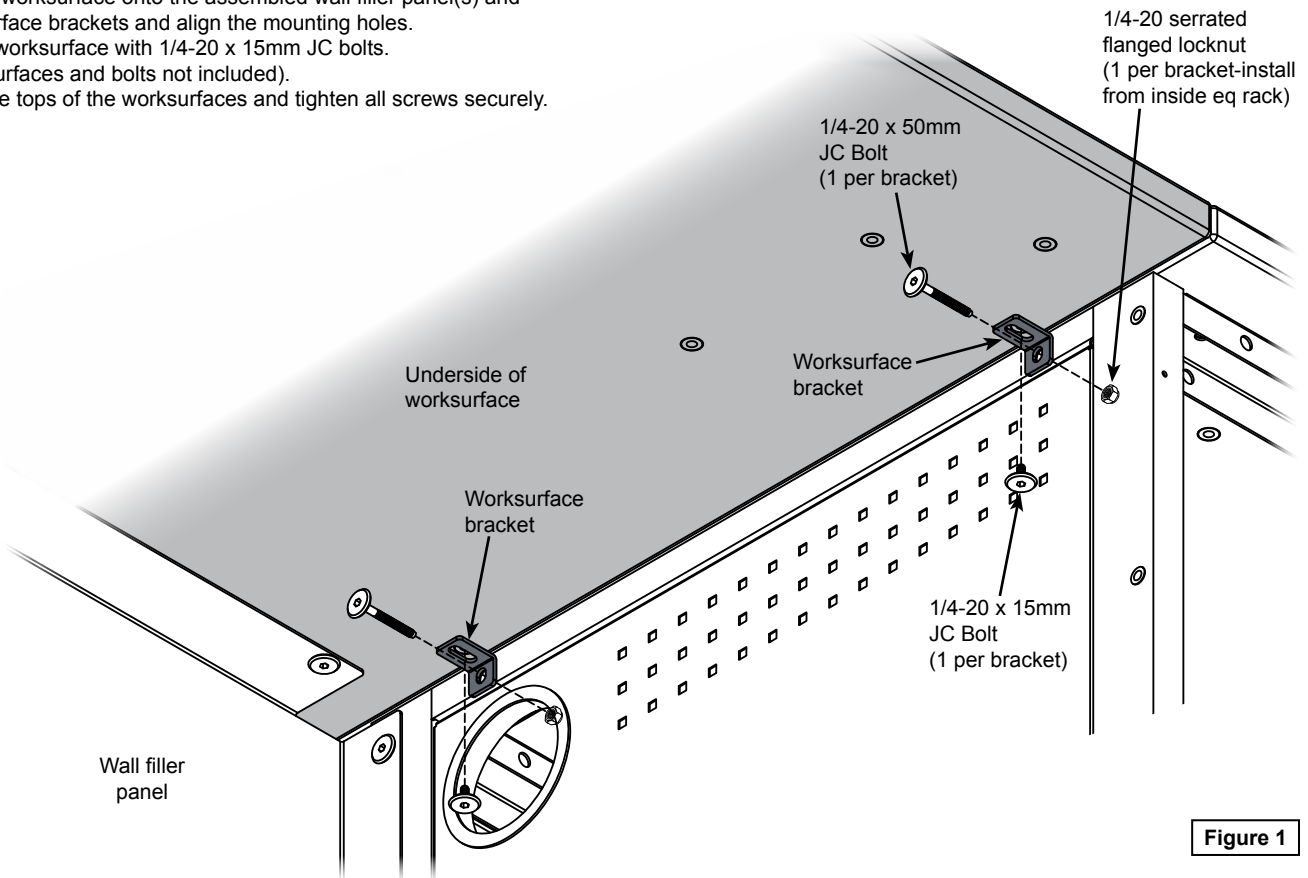

Figure 1