

# MOUNTING INSTRUCTIONS

# ECONO COMBO

- 1) Mount track to underside of work surface.
  - A. Make sure track is mounted square to front edge of work surface.
  - B. Front edge of track should be approximately 1/2" back from front of work surface
  - C. Drill (10) pilot holes for all holes of track using .125" diameter x 5/8" deep in underside of work surface for #8 x 5/8" screws provided.
  - D. Install (8) #8 x 5/8" lg. screws provided along both sides of track and (1) #8 x 5/8" lg. back center screw with bumper. Do not over tighten bumper screw.
- 2) To install palm rest: (Optional)
  - A. Place (2) threaded fasteners on palm rest bracket through holes in front half of clamp tray as shown. Fasten using (2) 10-24 nuts provided.
  - 3) Slide mechanism into grooves on track approximately 6".
  - 4) Loosen knob and lower arm mechanism to down position. Retighten knob.
  - 5) Slide mechanism back until it hits back bumper stop.
  - 6) Place track guard over end of track and mark (2) outside hole locations on work surface. Drill .125" dia. pilot holes 5/8" deep for (3) #8 x 5/8" screws provided. Install track guard. Do not over tighten.
  - 7) Raise arm mechanism to horizontal position.
- 8) To lock keyboard into clamp tray, loosen knob and extend front half of clamp. Center keyboard from left to right in clamp tray, push clamp back firmly, and tighten knob.
- 9) Depending on cord location on keyboard, mount cord restraints (2) on either right hand or left hand side of mechanism in approximate locations and orientations shown. To mount cord restraint, peel off protective paper and apply to clean surface.
- 10) To mount optional mousing surface:
  - Insert (2) #10-32 x 1 self tapping screws into the front countersunk holes in clamp tray and push (2) spacers onto screws. Tighten screws into 2 inside holes in square tube.
  - 11) Adjust mouse pan to desired usage position. Attach cord clip to rear, underside of of mousing surface. Tilt friction is preset at the factory. It may be adjusted by tightening or loosening the two acorn nuts (3/8" hex) if desired.

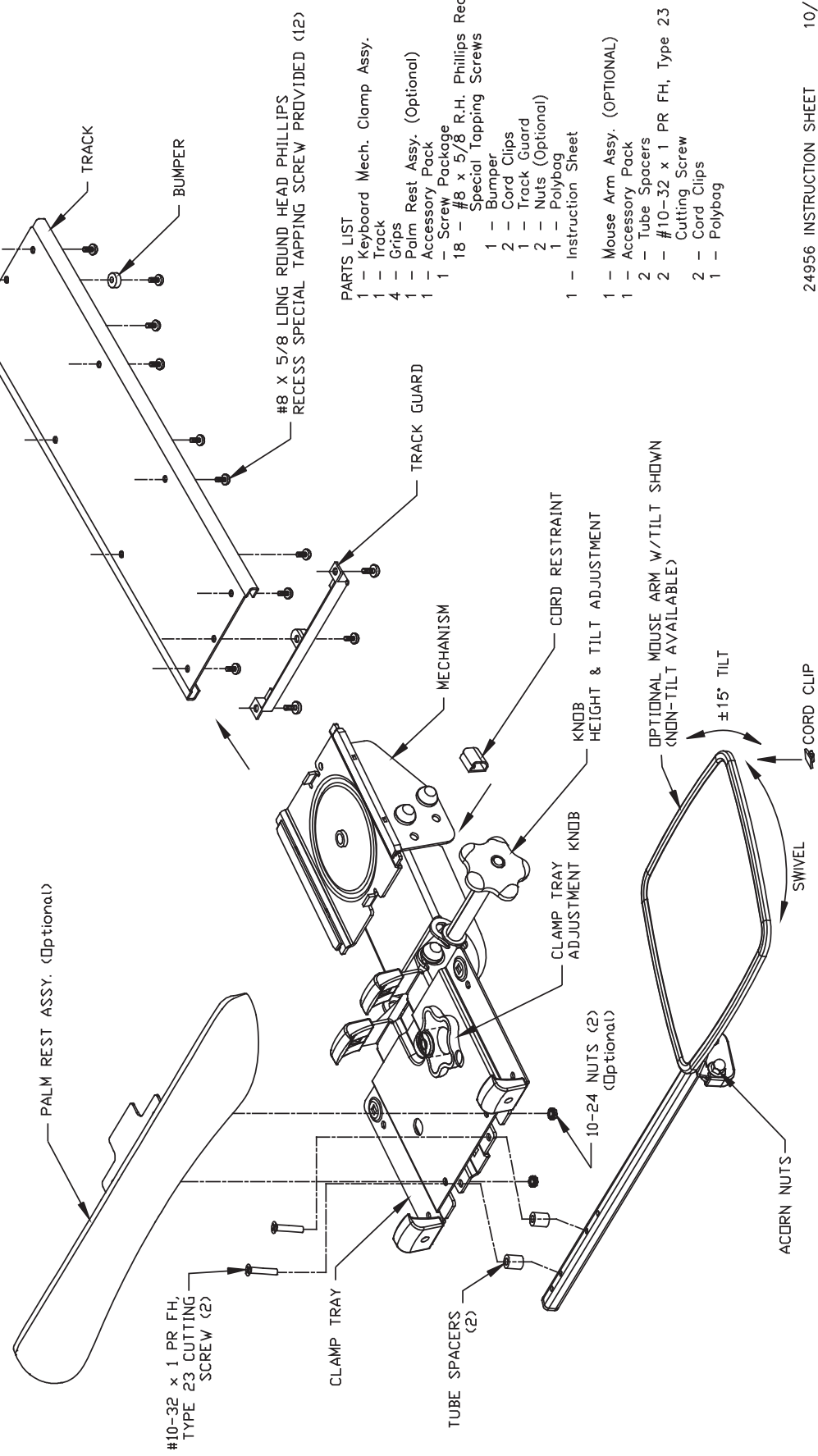

**PARTS LIST**

1	Keyboard Mech. Clamp Assy.
1	Track
4	Grips
1	Palm Rest Assy. (Optional)
1	Accessory Pack
1	Screw Package
18	#8 x 5/8 R.H. Phillips Recess Special Tapping Screws
1	Bumper
2	Cord Clips
1	Track Guard
2	Nuts (Optional)
1	Polybag
1	Instruction Sheet

1	Mouse Arm Assy. (OPTIONAL)
1	Accessory Pack
2	Tube Spacers
2	#10-32 x 1 PR FH, Type 23 Cutting Screw
2	Cord Clips
1	Polybag